

**FIRE DEPARTMENT CONNECTIONS TO BE INSTALLED AT THE FRONT OF EACH BUILDING. A FIRE HYDRANT SHALL BE INSTALLED WITHIN 100' OF EACH FDC (TO BE COORDINATED WITH MEP) SEE FDC CONNECTION DETAIL ON SHEET CS503)**

**A LOCK BOX TO ALLOW ACCESS BY FIRE DEPARTMENT SHALL BE INSTALLED AT THE FRONT OF EACH BUILDING**

**BUILDINGS TO BE EQUIPPED WITH FULLY AUTOMATIC FIRE SPRINKLERS**

**ALL UTILITIES SHALL BE UNDERGROUND EXCEPT FOR THE OVERHEAD ELECTRIC ALONG CLARKSVILLE ROAD**

**UTILITY PLAN LEGEND**

—W—	DOMESTIC WATER LINE
—FW—	FIRE WATER LINE
—G—	GAS LINE
—E&T—	ELECTRIC AND TELECOM LINE
—OE—	OVERHEAD ELECTRIC SERVICE LINE
—SS—	SANITARY SEWER LINE
—FM—	SANITARY FORCE MAIN

Date	Description	No.
2/15/2022	Revised per Township Comments	2
12/3/2021	Completeness Revisions	1

REVISIONS

*Chris Roche*

SIGNATURE CHRISTIAN ROCHE 11/12/2021  
PROFESSIONAL ENGINEER NJ Lic. No. 240E04988100

**LANGAN**  
Langan Engineering and Environmental Services, Inc.  
989 Lenox Drive, Suite 124  
Lawrenceville, NJ 08648

T: 609.282.8000 F: 609.282.8001 www.langan.com  
NJ CERTIFICATE OF AUTHORIZATION No. 246A2798490

Project  
**BRIDGE POINT 8 INDUSTRIAL PARK**  
WEST WINDSOR TOWNSHIP  
MERCER COUNTY NEW JERSEY

Drawing Title  
**OVERALL UTILITY PLAN**

Project No. 130172801	Drawing No. CU100
Date 12/03/2021	
Drawn By AMG	
Checked By CMR	

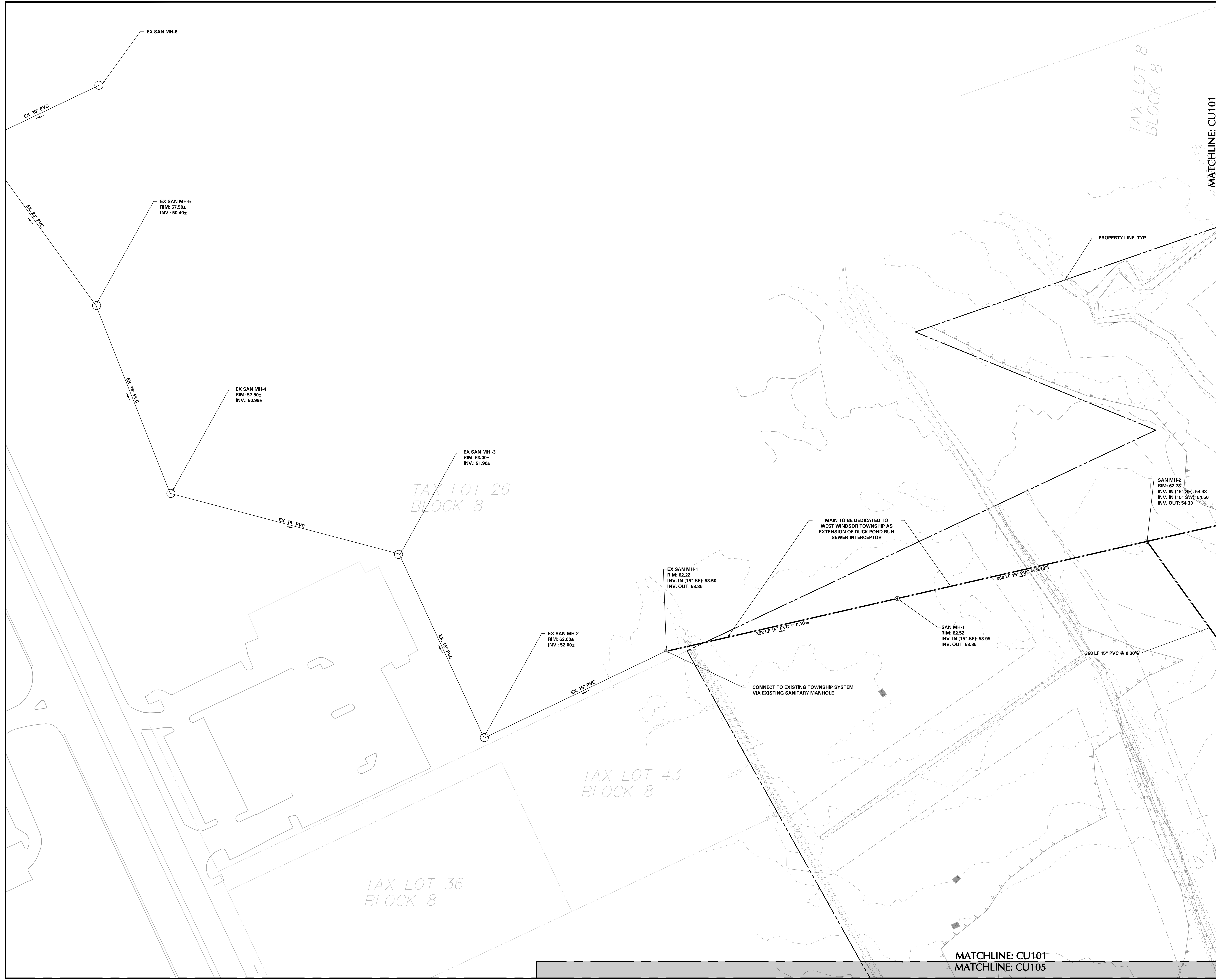

TAX LOT 8  
BLOCK 8

TAX LOT 26  
BLOCK 8

TAX LOT 43  
BLOCK 8

TAX LOT 36  
BLOCK 8

MATCHLINE: CU101  
MATCHLINE: CU102

MATCHLINE: CU101  
MATCHLINE: CU105

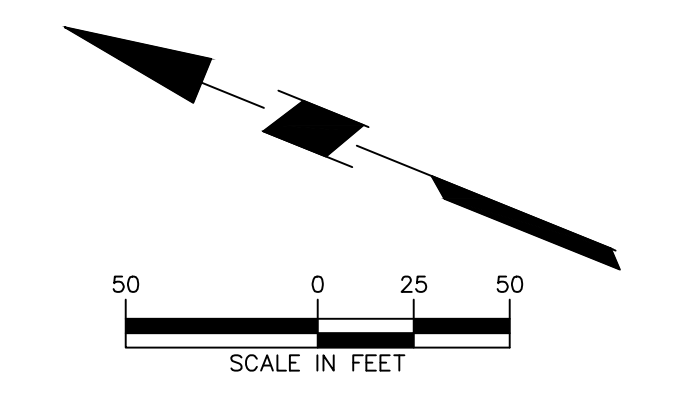

**SHEET LEGEND**

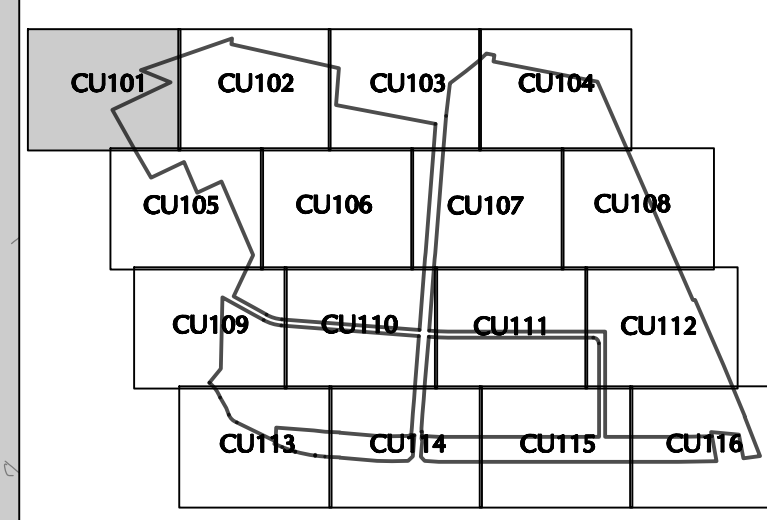

**UTILITY PLAN LEGEND**

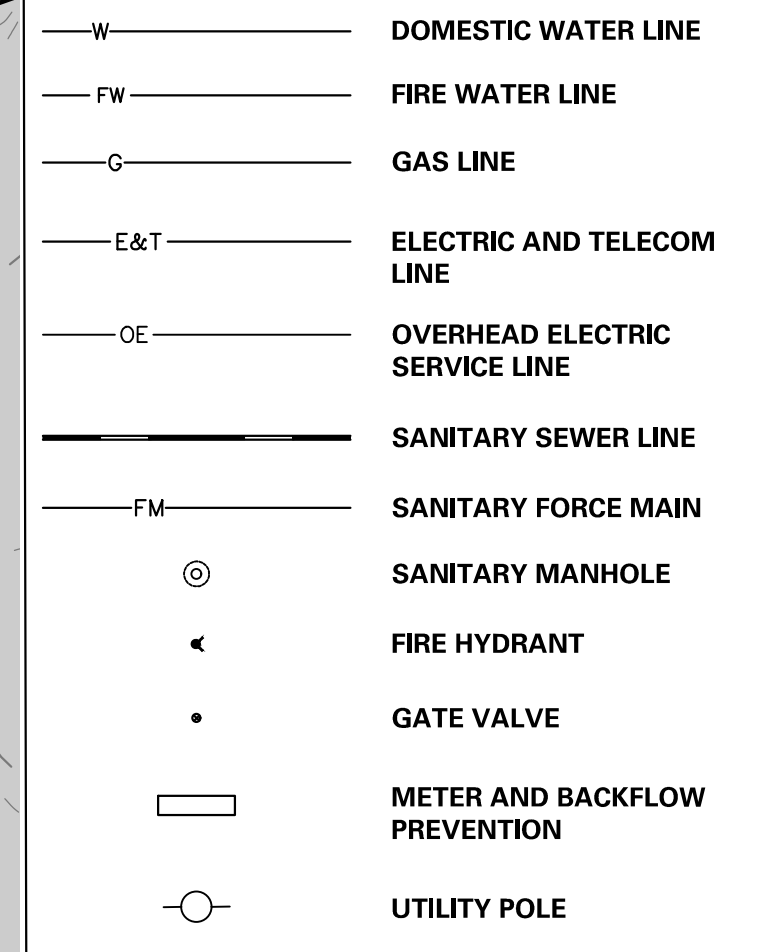

2/15/2022	Revised per Township Comments	2
12/3/2021	Completeness Revisions 1	1
Date	Description	No.

REVISIONS

*Chris Roche*  
 SIGNATURE CHRISTIAN ROCHE 11/12/2021  
 PROFESSIONAL ENGINEER NJ Lic. No. 245E04988100

**LANGAN**  
 Langan Engineering and Environmental Services, Inc.  
 989 Lenox Drive, Suite 124  
 Lawrenceville, NJ 08648  
 T: 609.282.8000 F: 609.282.8001 www.Langan.com  
 NJ CERTIFICATE OF AUTHORIZATION No. 245A2798490

Project  
**BRIDGE POINT 8 INDUSTRIAL PARK**  
 WEST WINDSOR TOWNSHIP  
 MERCER COUNTY NEW JERSEY  
 Drawing Title

**UTILITY PLAN I**

Project No.	130172801	Drawing No. <b>CU101</b>
Date	12/03/2021	
Drawn By	AMG	
Checked By	CMR	

LANGAN PROJECT NO. 130172801

MATCHLINE: CU101  
MATCHLINE: CU102

TAX LOT  
BLOCK  
MATCHLINE: CU102  
MATCHLINE: CU103

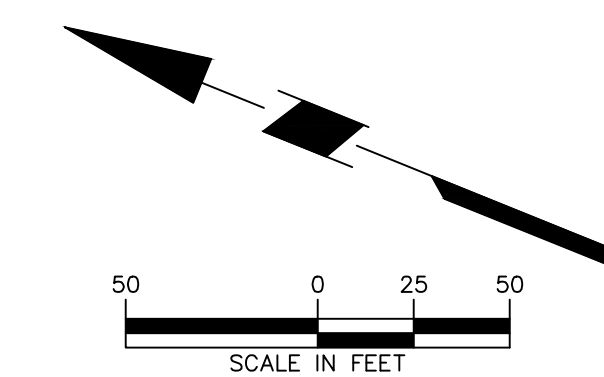

**SHEET LEGEND**

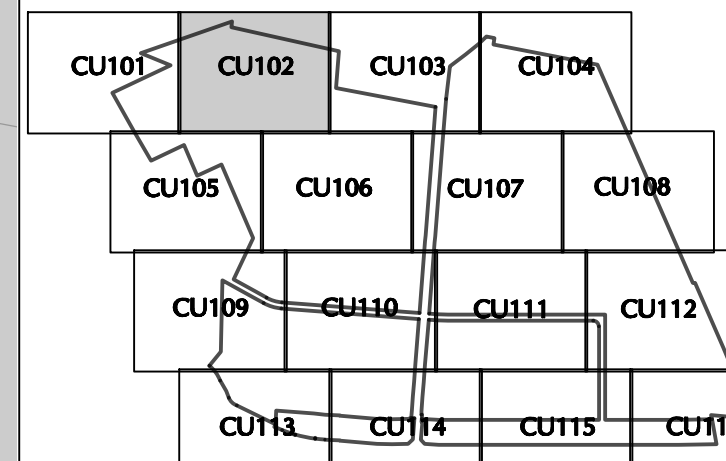

**UTILITY PLAN LEGEND**

- W — DOMESTIC WATER LINE
- FW — FIRE WATER LINE
- G — GAS LINE
- E&T — ELECTRIC AND TELECOM LINE
- OE — OVERHEAD ELECTRIC SERVICE LINE
- SS — SANITARY SEWER LINE
- FM — SANITARY FORCE MAIN
- ⊙ SANITARY MANHOLE
- ◀ FIRE HYDRANT
- GATE VALVE
- ▭ METER AND BACKFLOW PREVENTION
- UTILITY POLE

2/15/2022	Revised per Township Comments	2
12/3/2021	Completeness Revisions 1	1
Date	Description	No.

REVISIONS

*Chris Roche*

SIGNATURE CHRISTIAN ROCHE 11/12/2021  
PROFESSIONAL ENGINEER NJ Lic. No. 243E04988100

**LANGAN**

Langan Engineering and Environmental Services, Inc.  
989 Lenox Drive, Suite 124  
Lawrenceville, NJ 08648

T: 609.282.8000 F: 609.282.8001 www.langan.com  
NJ CERTIFICATE OF AUTHORIZATION No. 246A2798490

Project

**BRIDGE POINT 8 INDUSTRIAL PARK**

WEST WINDSOR TOWNSHIP

MERCER COUNTY NEW JERSEY

Drawing Title

**UTILITY PLAN II**

Project No.	Drawing No.
130172801	CU102
Date	Drawn By
12/03/2021	AMG
Checked By	CMR

MATCHLINE: CU102  
MATCHLINE: CU105

MATCHLINE: CU102  
MATCHLINE: CU106

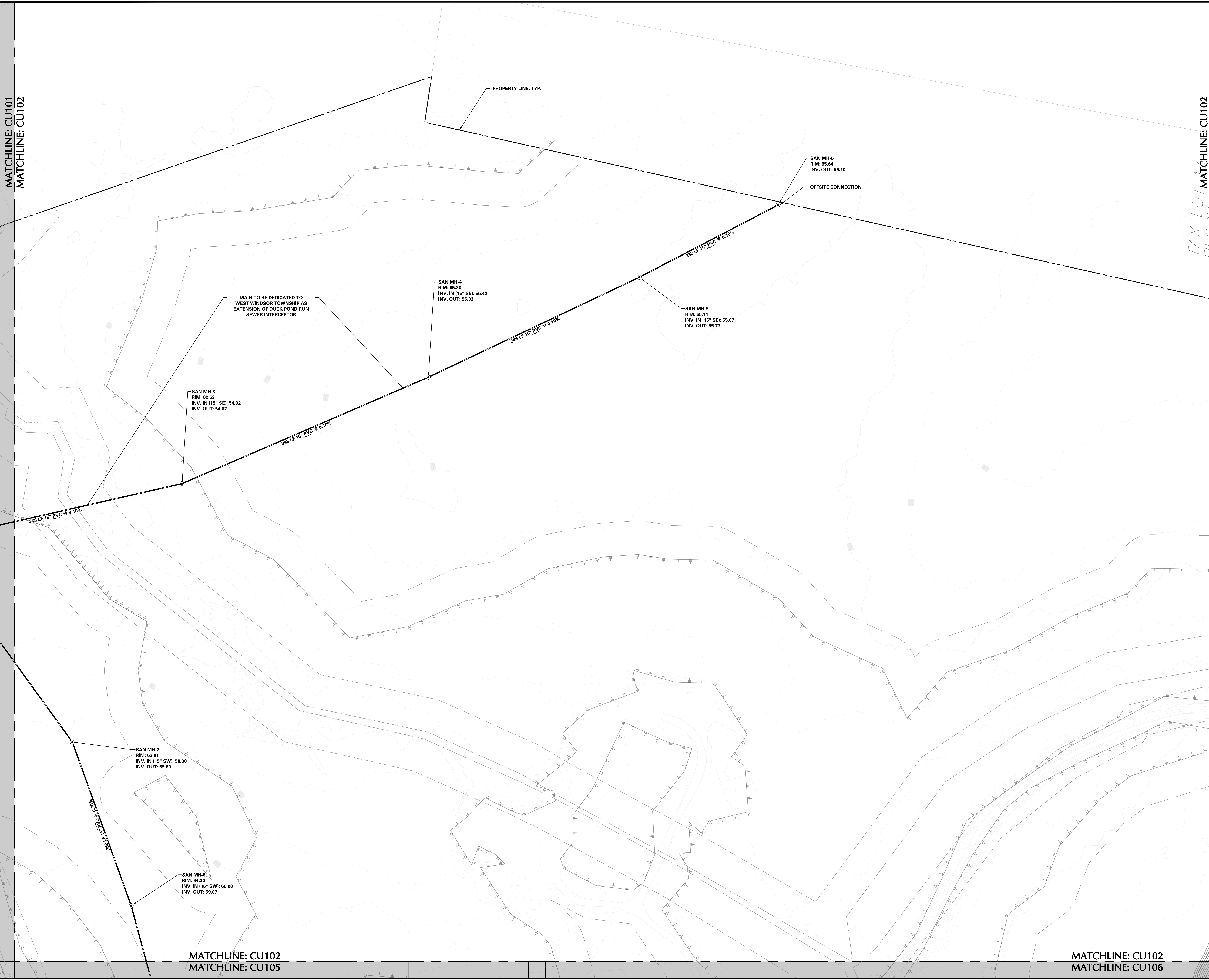

MATCHLINE: CU102  
MATCHLINE: CU103

BLOCK 8

MATCHLINE: CU103  
MATCHLINE: CU104

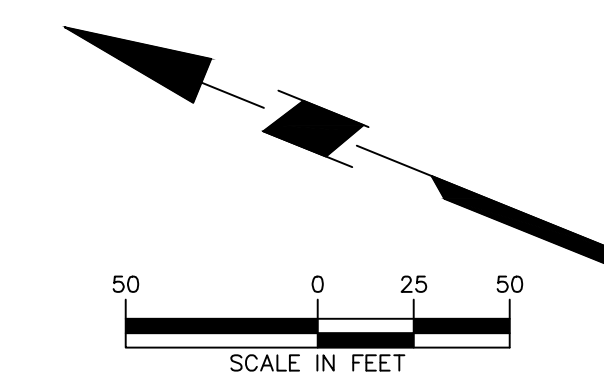

### SHEET LEGEND

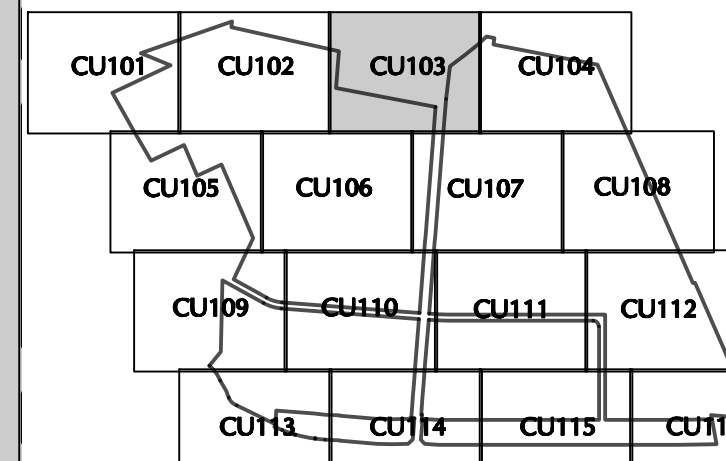

### UTILITY PLAN LEGEND

- W — DOMESTIC WATER LINE
- FW — FIRE WATER LINE
- C — GAS LINE
- E&T — ELECTRIC AND TELECOM LINE
- OE — OVERHEAD ELECTRIC SERVICE LINE
- SS — SANITARY SEWER LINE
- FM — SANITARY FORCE MAIN
- ⊙ — SANITARY MANHOLE
- < — FIRE HYDRANT
- — GATE VALVE
- ▭ — METER AND BACKFLOW PREVENTION
- — UTILITY POLE

2/15/2022	Revised per Township Comments	2
12/3/2021	Completeness Revisions 1	1
Date	Description	No.

#### REVISIONS

*Chris Roche*  
 SIGNATURE CHRISTIAN ROCHE 11/12/2021  
 PROFESSIONAL ENGINEER NJ Lic. No. 240E04988100

**LANGAN**  
 Langan Engineering and Environmental Services, Inc.  
 989 Lenox Drive, Suite 124  
 Lawrenceville, NJ 08648  
 T: 609.282.8000 F: 609.282.8001 www.langan.com  
 NJ CERTIFICATE OF AUTHORIZATION No. 246A2798499

Project  
**BRIDGE POINT 8 INDUSTRIAL PARK**  
 WEST WINDSOR TOWNSHIP  
 MERCER COUNTY NEW JERSEY

Drawing Title  
**UTILITY PLAN III**

Project No.	Drawing No.
130172801	CU103
Date	Drawn By
12/03/2021	AMG
Checked By	CMR

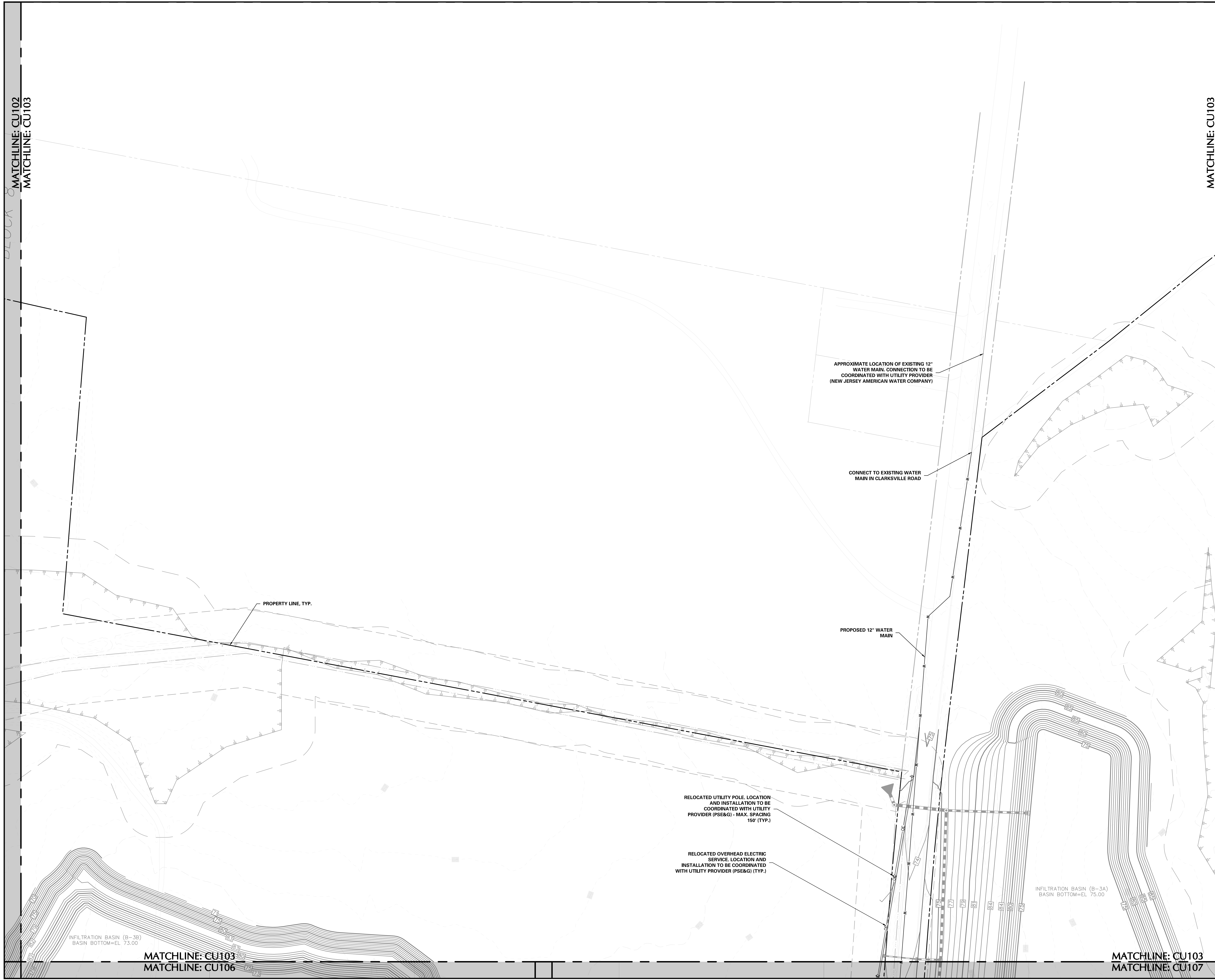

MATCHLINE: CU103  
MATCHLINE: CU106

MATCHLINE: CU103  
MATCHLINE: CU107

MATCHLINE: CU103  
MATCHLINE: CU104

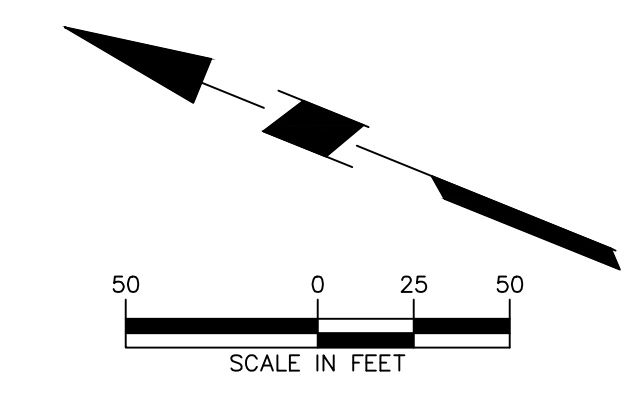

**SHEET LEGEND**

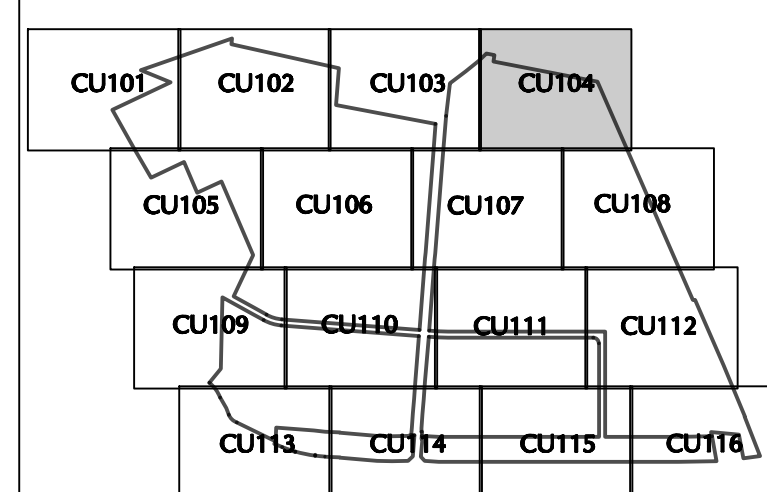

**UTILITY PLAN LEGEND**

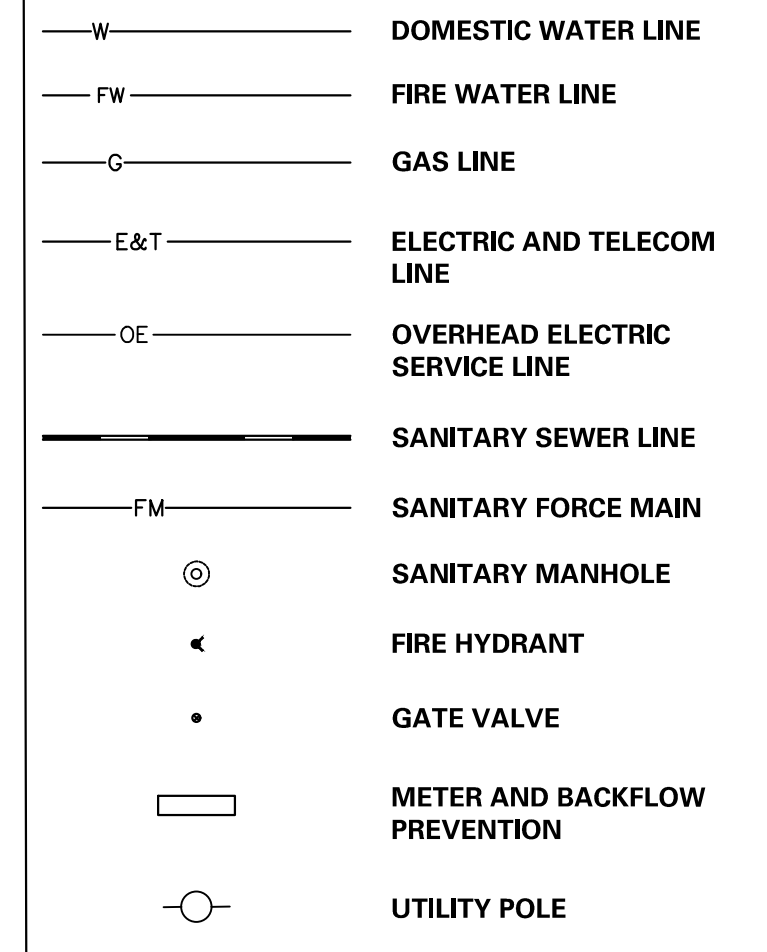

MATCHLINE: CU104  
MATCHLINE: CU107

MATCHLINE: CU104  
MATCHLINE: CU108



SAN MH-72  
RIM: 95.74  
INV. IN (8" SE): 89.74  
INV. OUT: 89.64

FIRE HYDRANT AND LATERAL (TYP.)

FIRE WATER LOOP (TYP.). FINAL SIZE TO BE COORDINATED WITH FIRE PROTECTION ENGINEER.  
SPRINKLER SERVICE (TYP.). FINAL LOCATION, NUMBER, AND SIZE TO BE COORDINATED WITH FIRE PROTECTION ENGINEER.

SAN CO-74  
RIM: 98.98  
INV. IN (8" S): 89.93  
INV. OUT: 89.93  
14 LF 8" PVC @ 0.50%  
SAN BLDG-27  
INV. OUT: 90.00  
39 LF 8" PVC @ 0.50%

EMPTY CONDUIT FOR POTENTIAL EV CHARGING

225 LF 8" PVC @ 0.50%

SAN MH-71  
RIM: 84.41  
INV. IN (8" E): 88.51  
INV. OUT: 88.41

FIRE DEPARTMENT CONNECTION TO BE CONFIRMED WITH MEP, TYP.

WATER SERVICE TO BUILDING. LOCATION TO BE COORDINATED WITH MEP ENGINEER.

NATURAL GAS SERVICE TO BUILDING. LOCATION AND SIZE TO BE COORDINATED WITH MEP ENGINEER.

ELECTRIC AND TELECOM SERVICE TO BUILDING. LOCATION AND SIZE TO BE COORDINATED WITH MEP ENGINEER.

FIRE HYDRANT SURROUNDED BY 4 BOLLARDS (TYP.)

A LOCK BOX TO ALLOW IMMEDIATE ACCESS BY THE FIRE DEPARTMENT SHALL BE INSTALLED AT THE FRONT OF EACH BUILDING

10" FIRE WATER AND 4" DOMESTIC WATER SERVICES (TYP.)

SAN MH-70  
RIM: 84.51  
INV. IN (8" E): 87.06  
INV. OUT: 86.96

224 LF 8" PVC @ 0.50%

ELECTRIC AND TELECOM SERVICE (TYP.)

GAS SERVICE (TYP.)

**A1**  
**334,032 SF**  
**FFE: 100.00**

**BUILDING A1 REQUIRES EMPTY CONDUIT FOR 4 EV SPACES**

2/15/2022	Revised per Township Comments	2
12/3/2021	Completeness Revisions 1	1
Date	Description	No.

REVISIONS

*Chris Roche*  
SIGNATURE CHRISTIAN ROCHE 11/12/2021  
PROFESSIONAL ENGINEER NJ Lic. No. 240E04988100

**LANGAN**  
Langan Engineering and Environmental Services, Inc.  
989 Lenox Drive, Suite 124  
Lawrenceville, NJ 08648  
T: 609.282.8000 F: 609.282.8001 www.langan.com  
NJ CERTIFICATE OF AUTHORIZATION No. 240A2798490

Project  
**BRIDGE POINT 8 INDUSTRIAL PARK**  
WEST WINDSOR TOWNSHIP  
MERCER COUNTY NEW JERSEY  
Drawing Title

**UTILITY PLAN IV**

Project No.	Drawing No.
130172801	CU104
Date	Drawn By
12/03/2021	AMG
Checked By	CMR

LANGAN  
PROJECT NO. 130172801

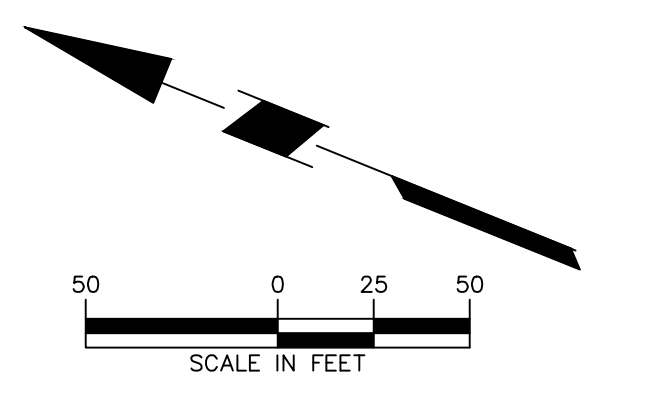

### SHEET LEGEND

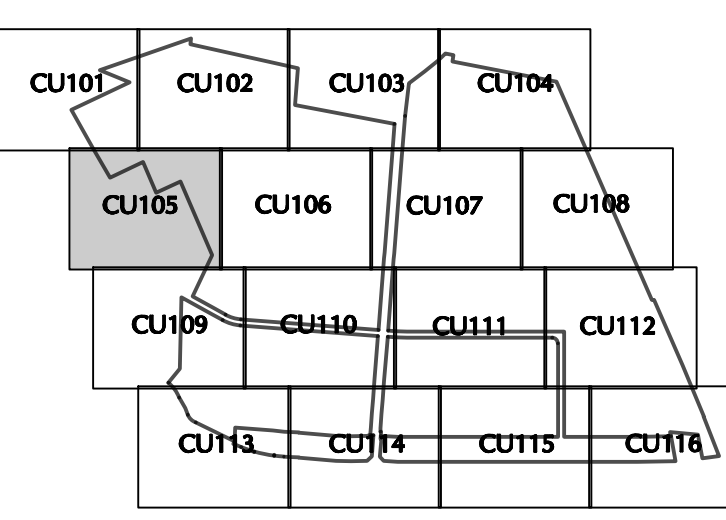

### UTILITY PLAN LEGEND

- W — DOMESTIC WATER LINE
- FW — FIRE WATER LINE
- C — GAS LINE
- E&T — ELECTRIC AND TELECOM LINE
- OE — OVERHEAD ELECTRIC SERVICE LINE
- SS — SANITARY SEWER LINE
- FM — SANITARY FORCE MAIN
- ⊙ — SANITARY MANHOLE
- < — FIRE HYDRANT
- — GATE VALVE
- ▭ — METER AND BACKFLOW PREVENTION
- — UTILITY POLE

Date	Description	No.
2/15/2022	Revised per Township Comments	2
12/3/2021	Completeness Revisions 1	1

#### REVISIONS

*Chris Roche*  
 SIGNATURE CHRISTIAN ROCHE 11/12/2021  
 PROFESSIONAL ENGINEER NJ Lic. No. 240E04888100

**LANGAN**  
 Langan Engineering and Environmental Services, Inc.  
 989 Lenox Drive, Suite 124  
 Lawrenceville, NJ 08648  
 T: 609.282.8000 F: 609.282.8001 www.langan.com  
 NJ CERTIFICATE OF AUTHORIZATION No. 246A2798490

Project No. 130172801  
 Drawing Title **BRIDGE POINT 8 INDUSTRIAL PARK**  
 WEST WINDSOR TOWNSHIP  
 MERCER COUNTY NEW JERSEY

### UTILITY PLAN V

Project No.	130172801	Drawing No.	<b>CU105</b>
Date	12/03/2021	Drawn By	
Checked By	AMG		
	CMR		



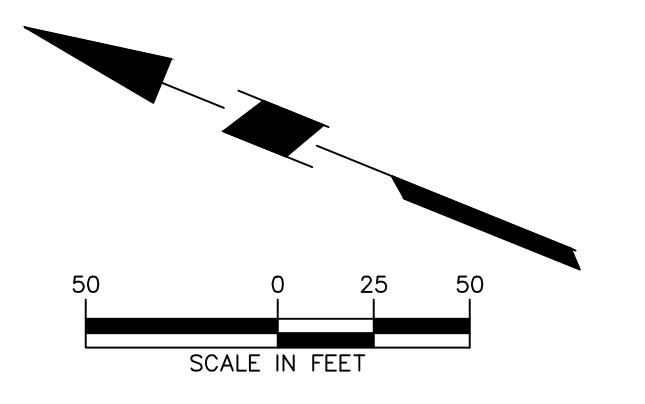
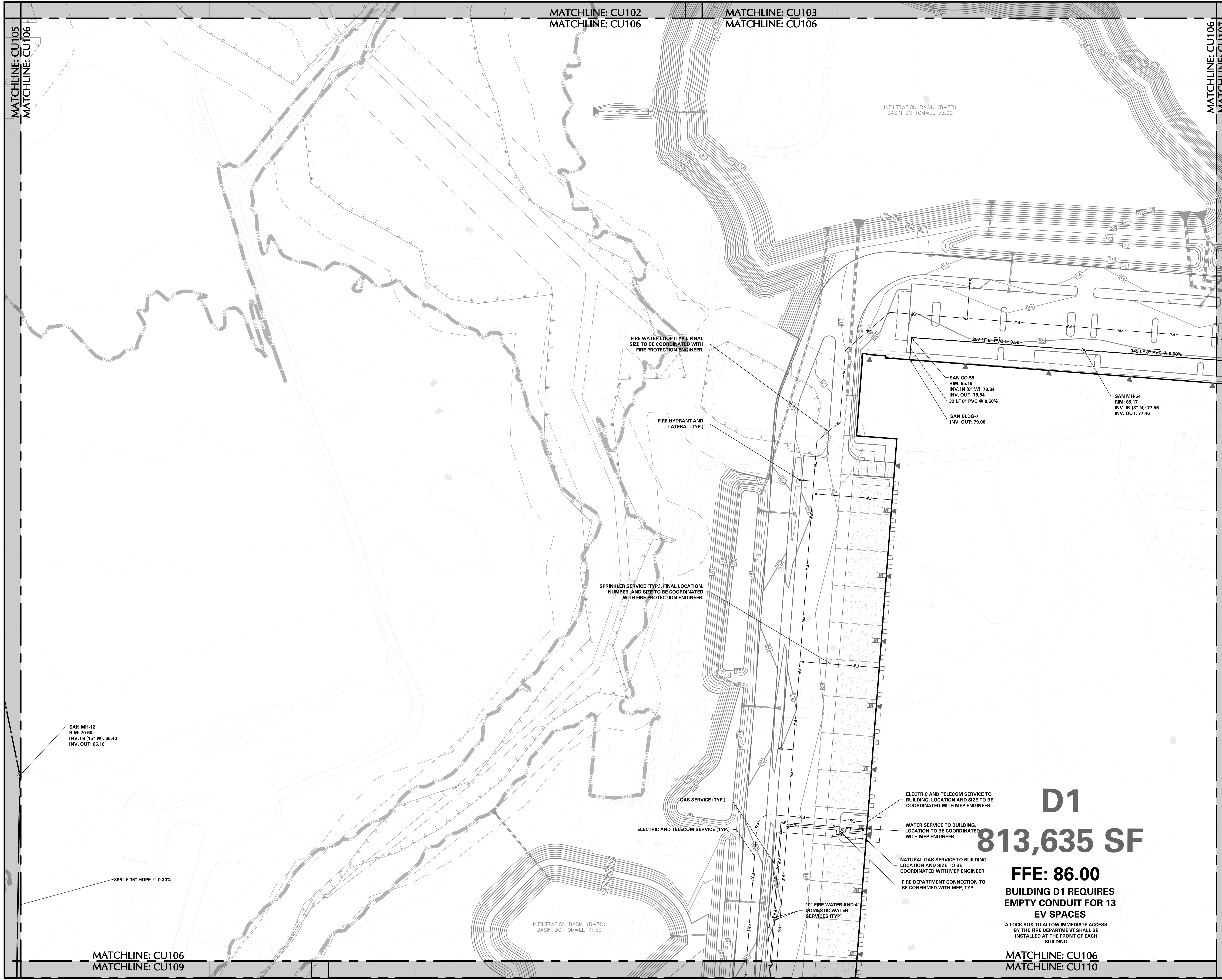

**SHEET LEGEND**

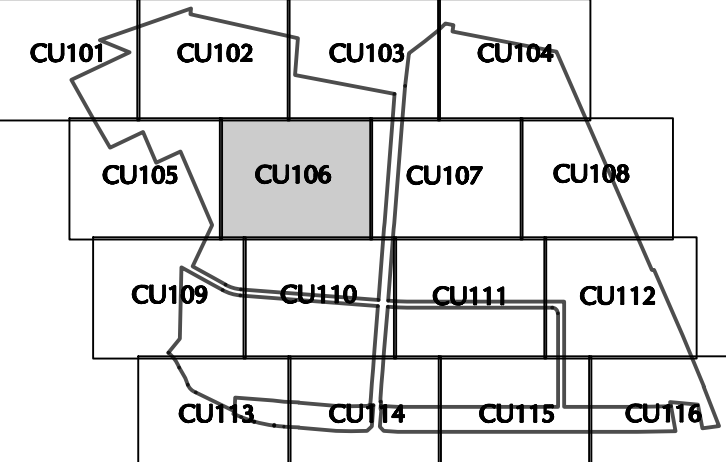

**UTILITY PLAN LEGEND**

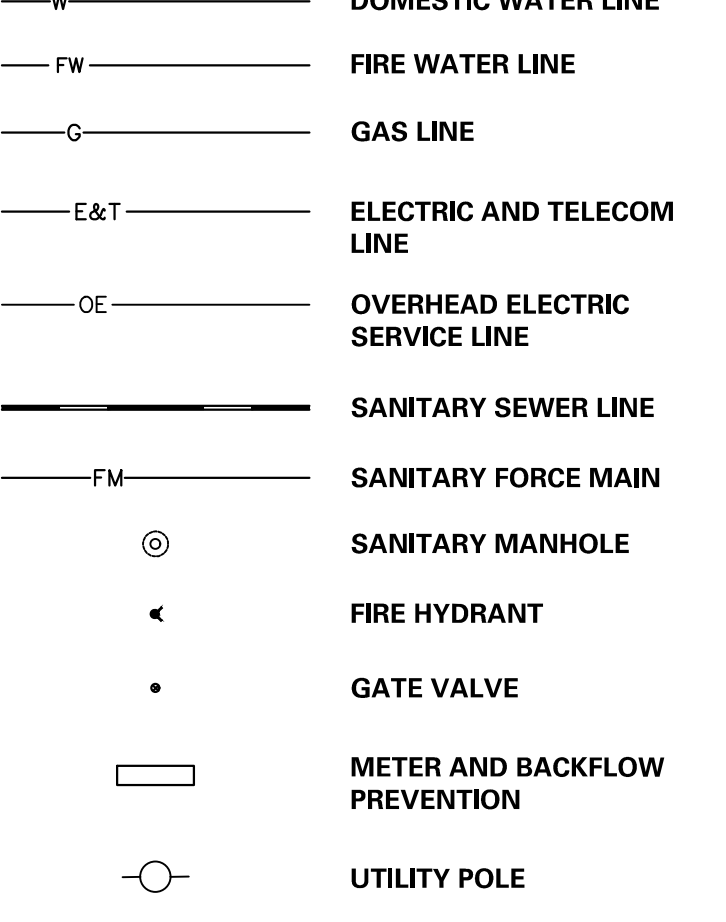

Date	Description	No.
2/15/2022	Revised per Township Comments	2
12/3/2021	Completeness Revisions	1

**REVISIONS**

*Chris Roche*  
 SIGNATURE CHRISTIAN ROCHE 11/12/2021  
 PROFESSIONAL ENGINEER NJ Lic. No. 240E04988100

**LANGAN**  
 Langan Engineering and Environmental Services, Inc.  
 989 Lenox Drive, Suite 124  
 Lawrenceville, NJ 08648  
 T: 609.282.8000 F: 609.282.8001 www.langan.com  
 NJ CERTIFICATE OF AUTHORIZATION No. 246A2798499

Project No. **130172801**  
**BRIDGE POINT 8 INDUSTRIAL PARK**  
 WEST WINDSOR TOWNSHIP  
 MERCER COUNTY NEW JERSEY  
 Drawing Title

**UTILITY PLAN VI**  
 Project No. **130172801**  
 Date **12/03/2021**  
 Drawing No. **CU106**  
 Drawn By **AMG**  
 Checked By **CMR**

**D1**  
**813,635 SF**  
**FFE: 86.00**  
**BUILDING D1 REQUIRES**  
**EMPTY CONDUIT FOR 13**  
**EV SPACES**  
 A LOCK BOX TO ALLOW IMMEDIATE ACCESS BY THE FIRE DEPARTMENT SHALL BE INSTALLED AT THE FRONT OF EACH BUILDING  
**MATCHLINE: CU106**  
**MATCHLINE: CU110**

MATCHLINE: CU105  
 MATCHLINE: CU106

MATCHLINE: CU102  
 MATCHLINE: CU106

MATCHLINE: CU103  
 MATCHLINE: CU106

MATCHLINE: CU106  
 MATCHLINE: CU107

MATCHLINE: CU106  
 MATCHLINE: CU109

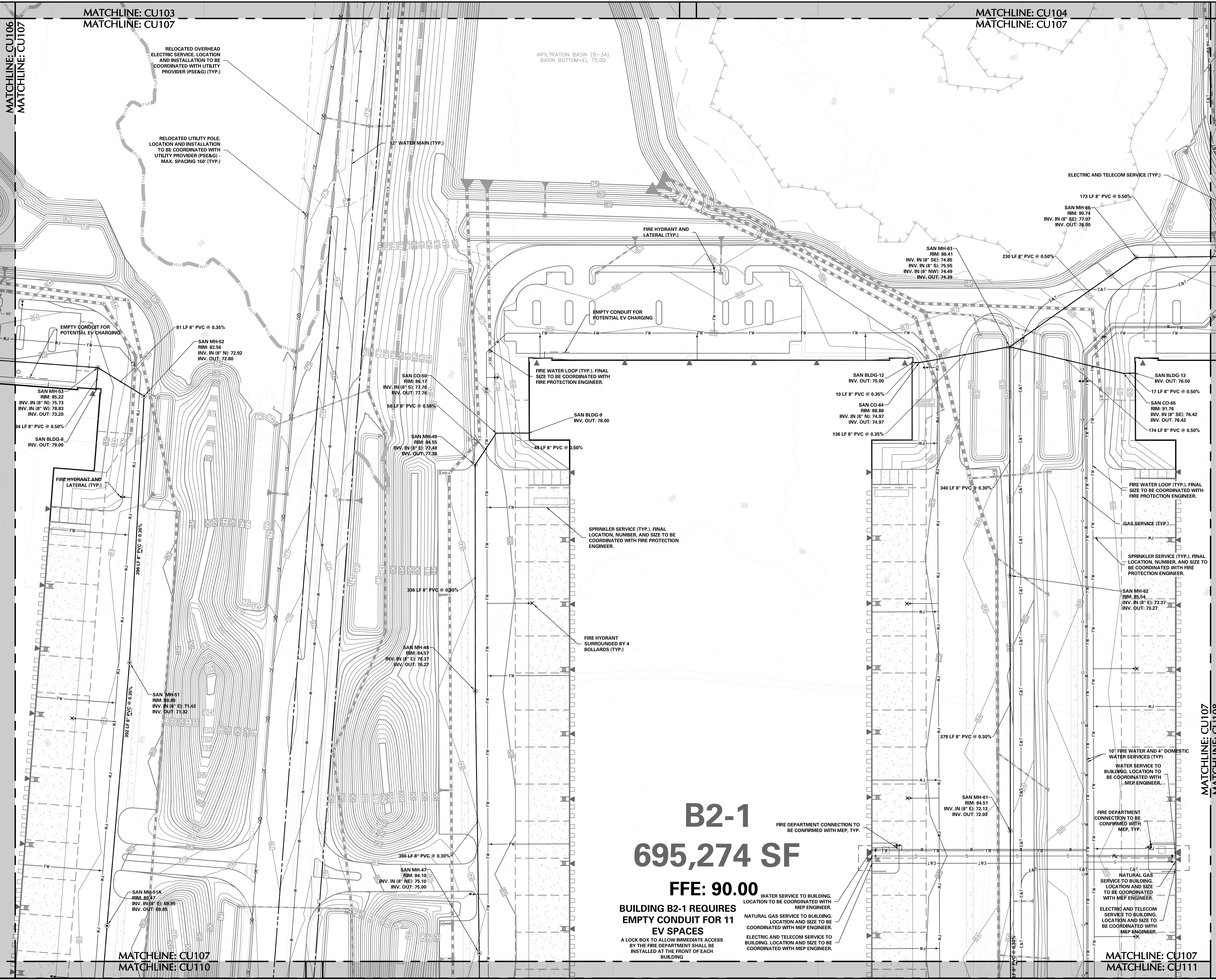

MATCHLINE: CU103  
MATCHLINE: CU107

MATCHLINE: CU104  
MATCHLINE: CU107

MATCHLINE: CU106  
MATCHLINE: CU107

50 0 25 50  
SCALE IN FEET

**SHEET LEGEND**

CU101	CU102	CU103	CU104
CU105	CU106	CU107	CU108
CU109	CU110	CU111	CU112
CU113	CU114	CU115	CU116

**UTILITY PLAN LEGEND**

—	DOMESTIC WATER LINE
FW	FIRE WATER LINE
—	GAS LINE
E&T	ELECTRIC AND TELECOM LINE
OE	OVERHEAD ELECTRIC SERVICE LINE
—	SANITARY SEWER LINE
FM	SANITARY FORCE MAIN
⊙	SANITARY MANHOLE
⊙	FIRE HYDRANT
⊙	GATE VALVE
⊙	METER AND BACKFLOW PREVENTION
⊙	UTILITY POLE

2/15/2021	Revised per Township Comments	2
12/3/2021	Completeness Revisions 1	1
Date	Description	No.

REVISIONS

*Chris Roche*

SIGNATURE: CHRISTIAN ROCHE 11/12/2021  
PROFESSIONAL ENGINEER NJ Lic. No. 240E04988100

**LANGAN**  
Langan Engineering and Environmental Services, Inc.  
989 Lenox Drive, Suite 124  
Lawrenceville, NJ 08648

T: 609.282.8000 F: 609.282.8001 www.langan.com  
NJ CERTIFICATE OF AUTHORIZATION No. 246A2798469

Project: **BRIDGE POINT 8 INDUSTRIAL PARK**  
WEST WINDSOR TOWNSHIP  
MERCER COUNTY NEW JERSEY

Drawing Title: **UTILITY PLAN VII**

Project No.	Drawing No.
130172801	CU107
Date	12/03/2021
Drawn By	AMG
Checked By	CMR

**B2-1**  
**695,274 SF**  
**FFE: 90.00**

**BUILDING B2-1 REQUIRES EMPTY CONDUIT FOR 11 EV SPACES**  
A LOCK BOX TO ALLOW IMMEDIATE ACCESS BY THE FIRE DEPARTMENT SHALL BE INSTALLED AT THE FRONT OF EACH BUILDING

WATER SERVICE TO BUILDING. LOCATION TO BE COORDINATED WITH MEP ENGINEER.  
NATURAL GAS SERVICE TO BUILDING. LOCATION AND SIZE TO BE COORDINATED WITH MEP ENGINEER.  
ELECTRIC AND TELECOM SERVICE TO BUILDING. LOCATION AND SIZE TO BE COORDINATED WITH MEP ENGINEER.

MATCHLINE: CU107  
MATCHLINE: CU111

MATCHLINE: CU107  
MATCHLINE: CU110



MATCHLINE: CU104  
MATCHLINE: CU108

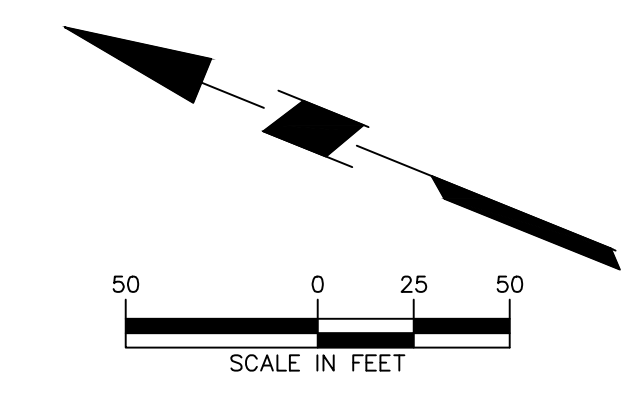

**SHEET LEGEND**

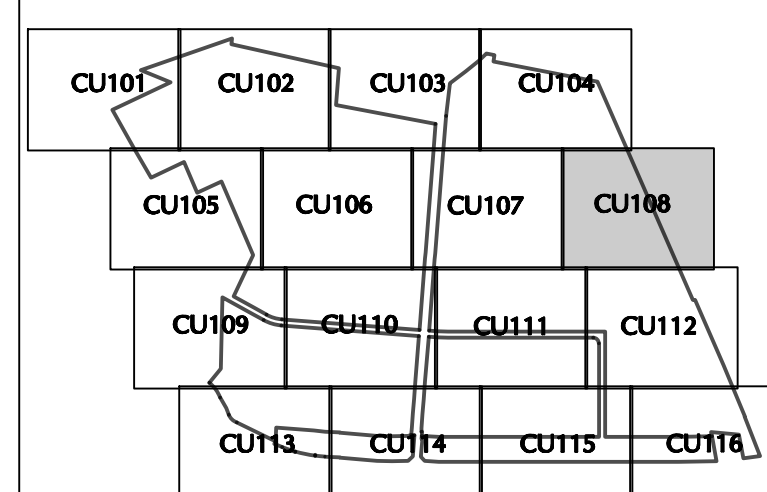

**UTILITY PLAN LEGEND**

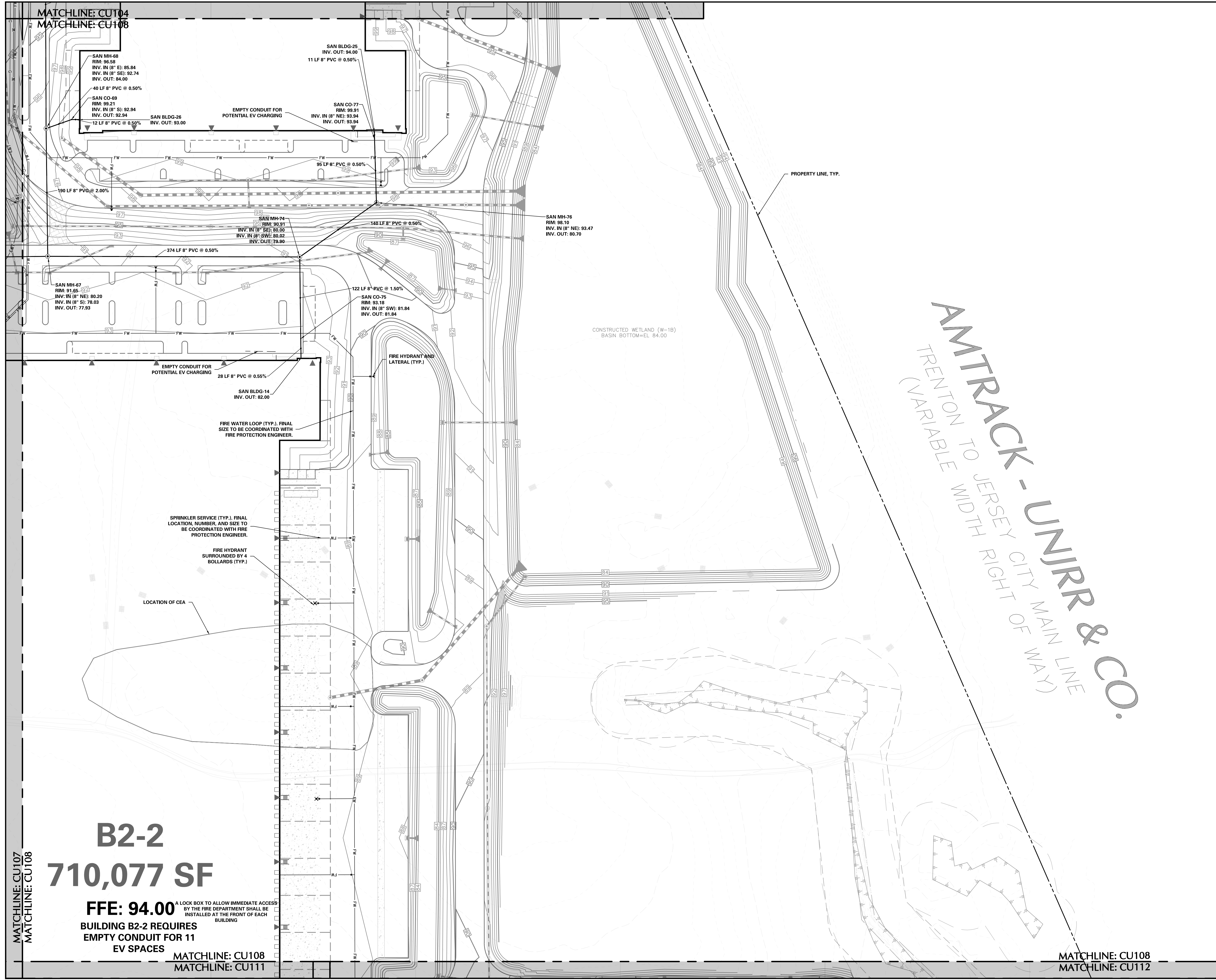
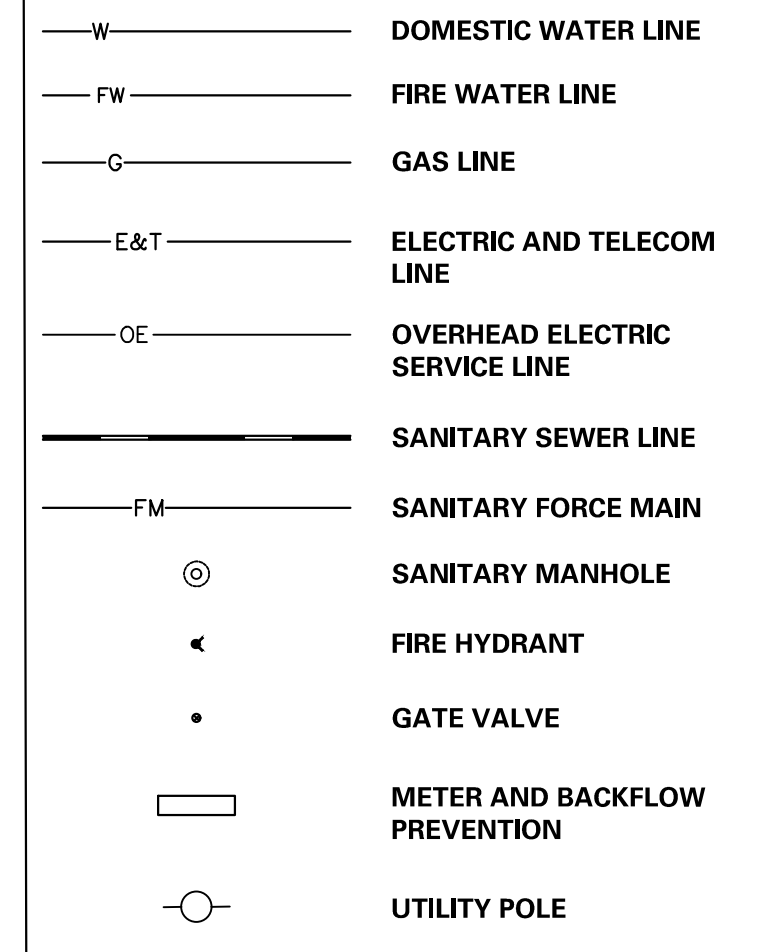

AMTRACK - UNRRR & CO.  
 TRENTON TO JERSEY CITY MAIN LINE  
 (VARIABLE WIDTH RIGHT OF WAY)

**B2-2**  
**710,077 SF**

**FFE: 94.00**  
A LOCK BOX TO ALLOW IMMEDIATE ACCESS BY THE FIRE DEPARTMENT SHALL BE INSTALLED AT THE FRONT OF EACH BUILDING

**BUILDING B2-2 REQUIRES EMPTY CONDUIT FOR 11 EV SPACES**

MATCHLINE: CU108  
MATCHLINE: CU111

2/15/2022	Revised per Township Comments	2
12/3/2021	Completeness Revisions 1	1
Date	Description	No.

REVISIONS

*Chris Roche*  
 SIGNATURE CHRISTIAN ROCHE 11/12/2021  
 PROFESSIONAL ENGINEER NJ Lic. No. 240E04988100

**LANGAN**  
 Langan Engineering and Environmental Services, Inc.  
 989 Lenox Drive, Suite 124  
 Lawrenceville, NJ 08648

T: 609.282.8000 F: 609.282.8001 www.langan.com  
 NJ CERTIFICATE OF AUTHORIZATION No. 246A2798490

Project  
**BRIDGE POINT 8 INDUSTRIAL PARK**  
 WEST WINDSOR TOWNSHIP  
 MERCER COUNTY NEW JERSEY

**UTILITY PLAN VIII**

Project No.	Drawing No.
130172801	<b>CU108</b>
Date	
12/03/2021	
Drawn By	
Checked By	
AMG	
CMR	

MATCHLINE: CU108  
MATCHLINE: CU112

MATCHLINE: CU107  
MATCHLINE: CU108

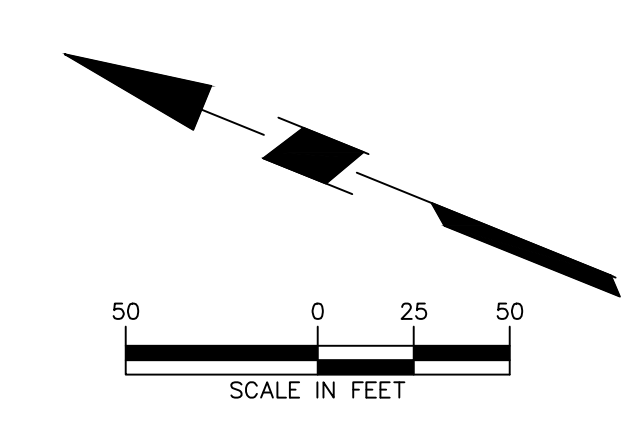
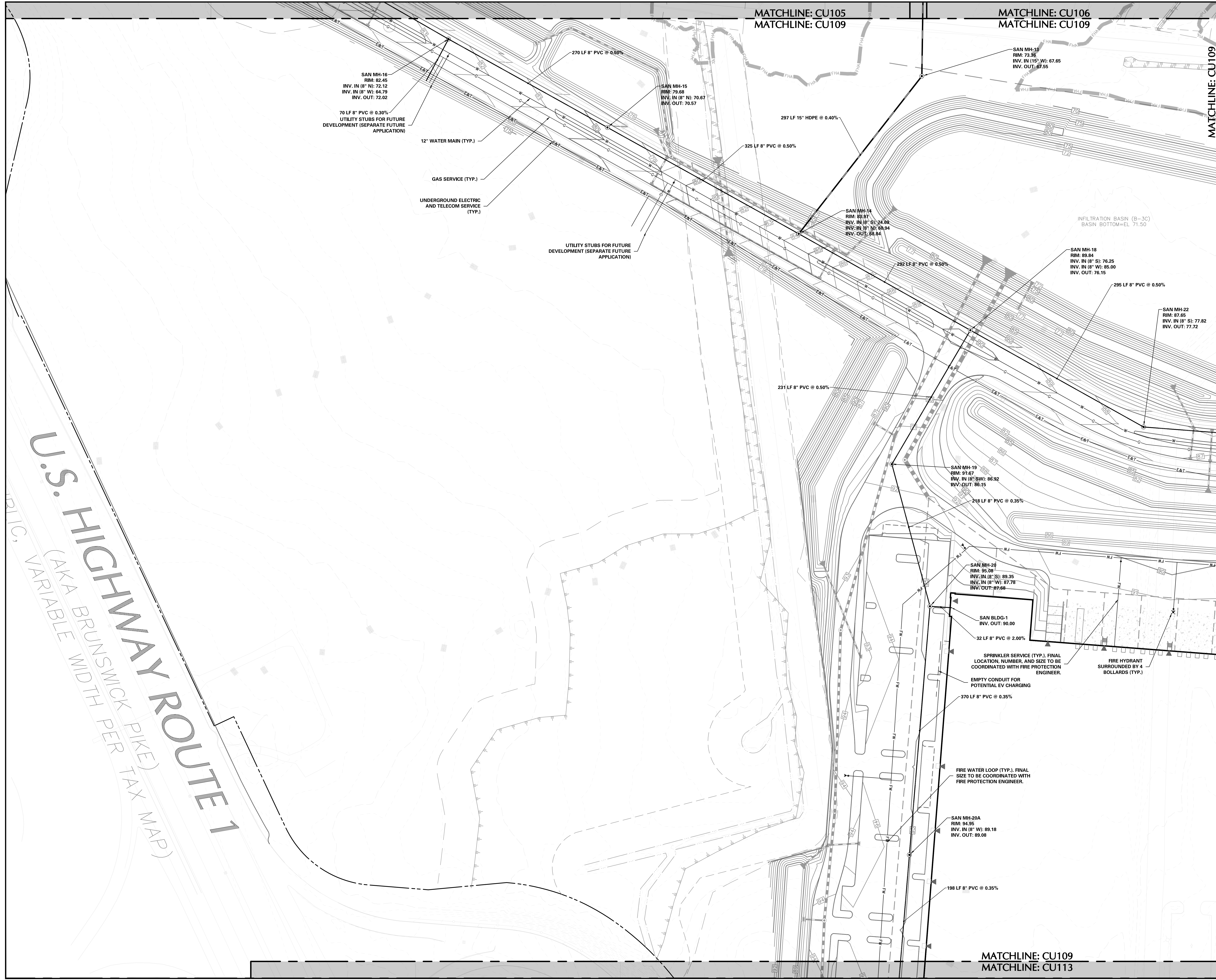

**SHEET LEGEND**

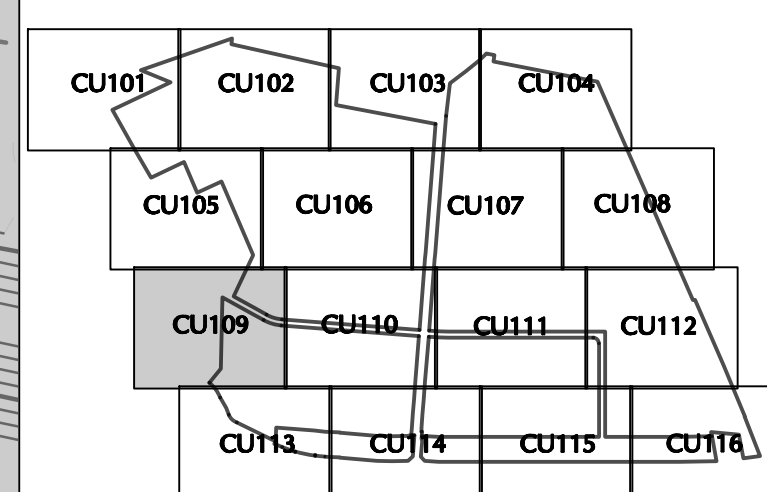

**UTILITY PLAN LEGEND**

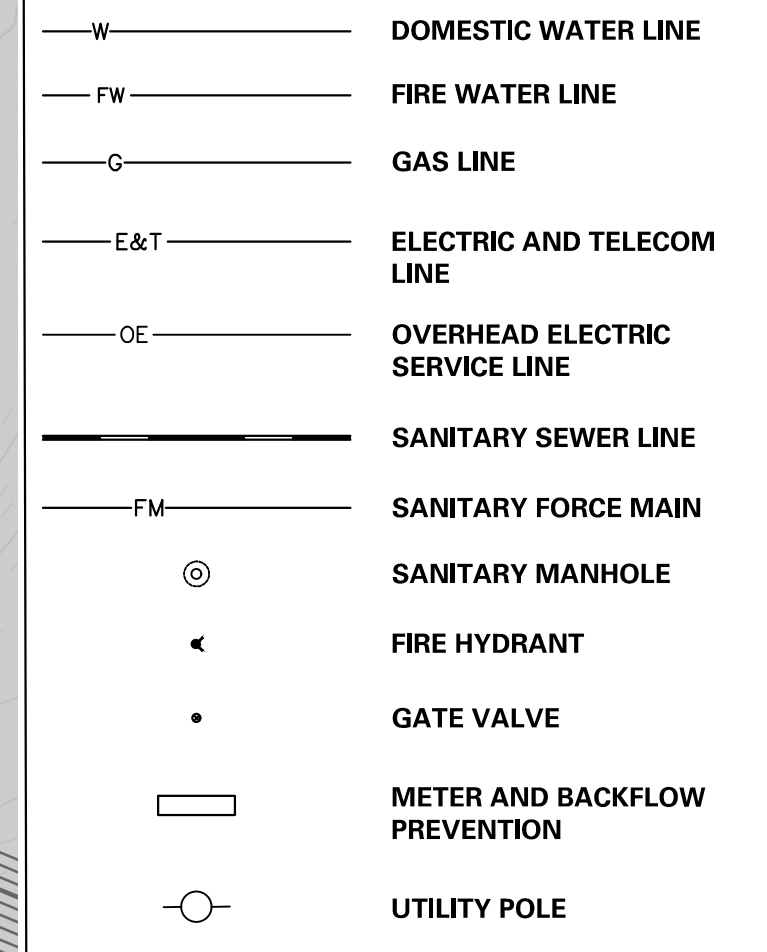

2/15/2022	Revised per Township Comments	2
12/3/2021	Completeness Revisions 1	1
Date	Description	No.

REVISIONS

*Chris Roche*  
 SIGNATURE CHRISTIAN ROCHE 11/12/2021  
 PROFESSIONAL ENGINEER NJ Lic. No. 240E04888100

**LANGAN**  
 Langan Engineering and Environmental Services, Inc.  
 989 Lenox Drive, Suite 124  
 Lawrenceville, NJ 08648  
 T: 609.282.8000 F: 609.282.8001 www.langan.com  
 NJ CERTIFICATE OF AUTHORIZATION No. 246A2798490

Project  
**BRIDGE POINT 8 INDUSTRIAL PARK**  
 WEST WINDSOR TOWNSHIP  
 MERCER COUNTY NEW JERSEY  
 Drawing Title

**UTILITY PLAN IX**

Project No.	Drawing No.
130172801	CU109
Date	Drawn By
12/03/2021	AMG
Checked By	CMR

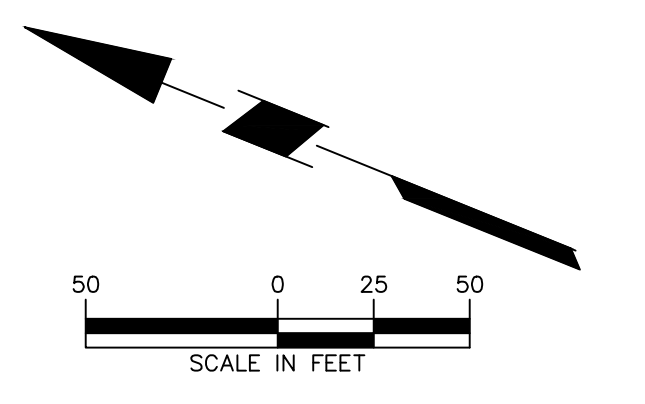
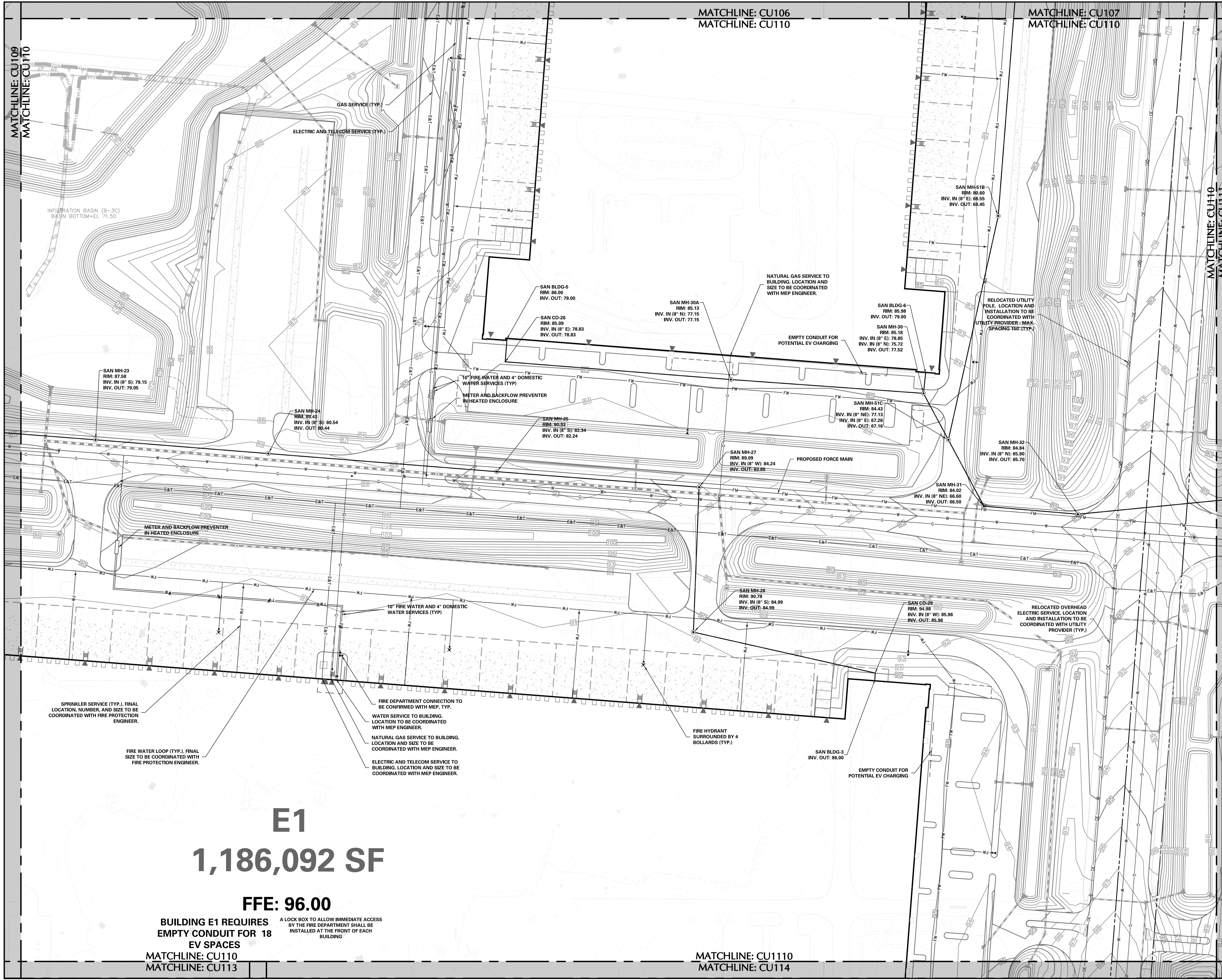

**SHEET LEGEND**

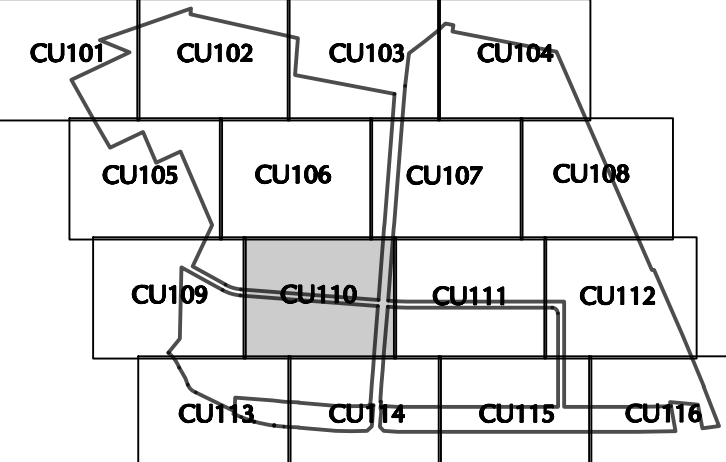

**UTILITY PLAN LEGEND**

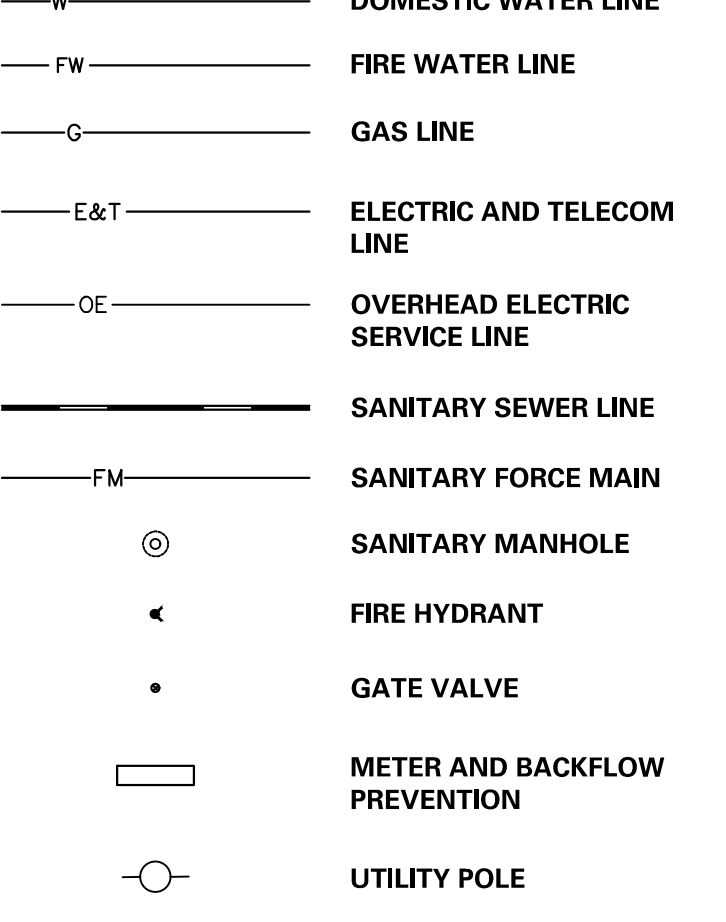

2/15/2021	Revised per Township Comments	2
12/3/2021	Completeness Revisions 1	1
Date	Description	No.

REVISIONS

*Chris Roche*  
 SIGNATURE CHRISTIAN ROCHE 11/12/2021  
 PROFESSIONAL ENGINEER NJ Lic. No. 240E04988100

**LANGAN**  
 Langan Engineering and Environmental Services, Inc.  
 989 Lenox Drive, Suite 124  
 Lawrenceville, NJ 08648  
 T: 609.282.8000 F: 609.282.8001 www.langan.com  
 NJ CERTIFICATE OF AUTHORIZATION No. 246A2798469

Project  
**BRIDGE POINT 8 INDUSTRIAL PARK**  
 WEST WINDSOR TOWNSHIP  
 MERCER COUNTY NEW JERSEY  
 Drawing Title

**UTILITY PLAN X**

Project No.	130172801	Drawing No.	<b>CU110</b>
Date	12/03/2021	Drawn By	
Checked By	AMG		
	CMR		

**E1**  
**1,186,092 SF**

**FFE: 96.00**

**BUILDING E1 REQUIRES  
 EMPTY CONDUIT FOR 18  
 EV SPACES**  
 MATCHLINE: CU110  
 MATCHLINE: CU113

A LOCK BOX TO ALLOW IMMEDIATE ACCESS BY THE FIRE DEPARTMENT SHALL BE INSTALLED AT THE FRONT OF EACH BUILDING

MATCHLINE: CU110  
 MATCHLINE: CU114

PROJECT NO. 130172801

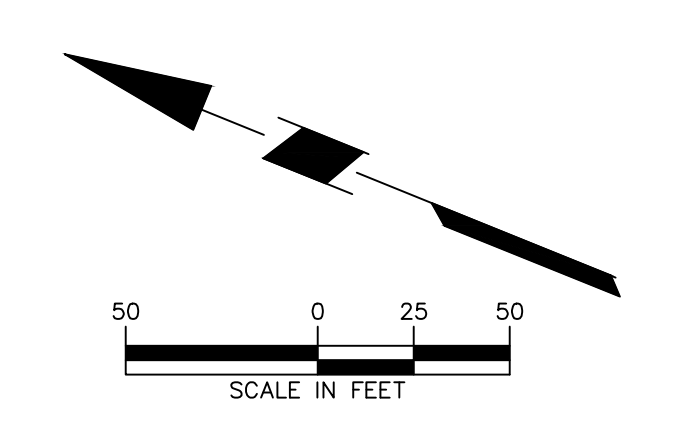
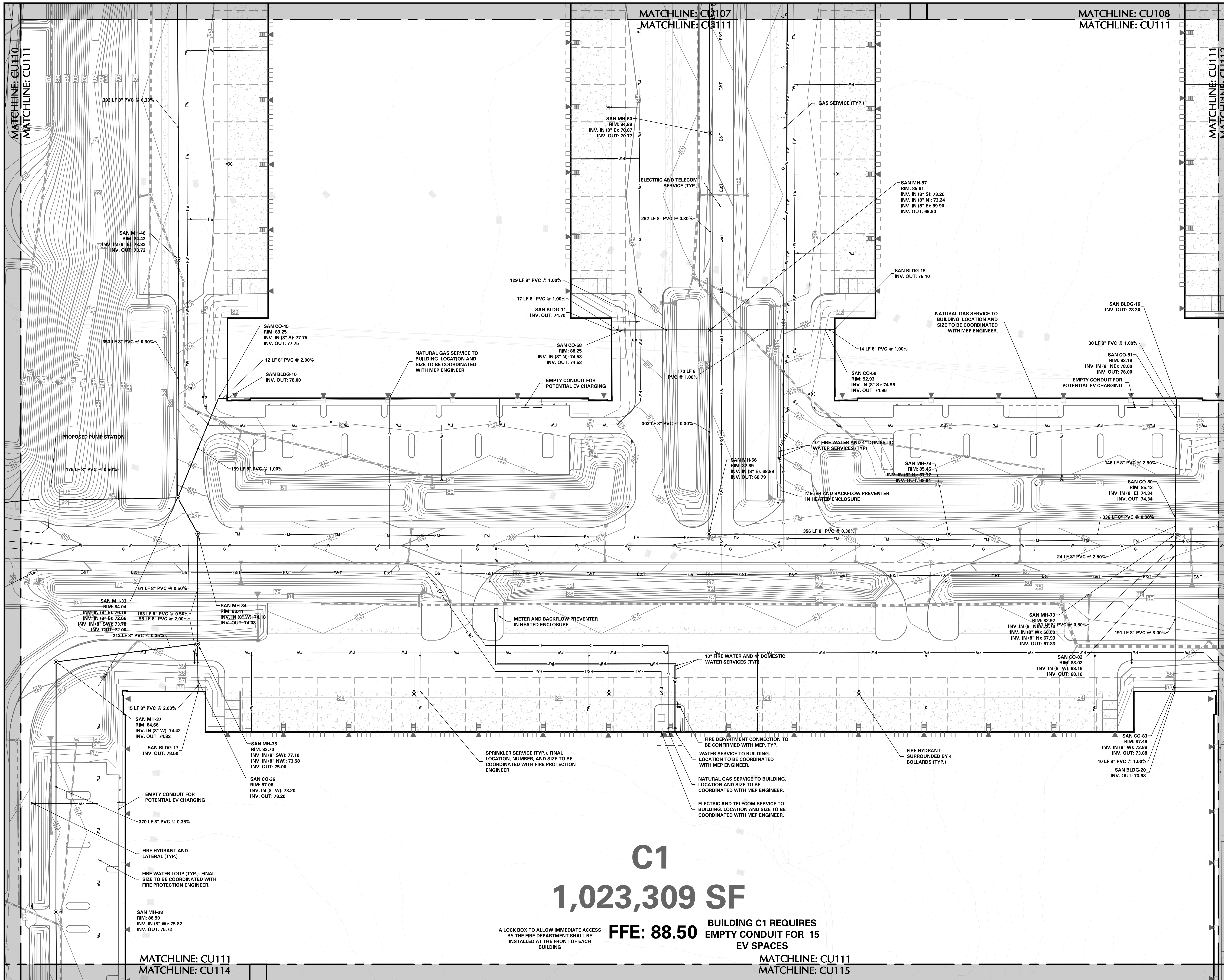

**SHEET LEGEND**

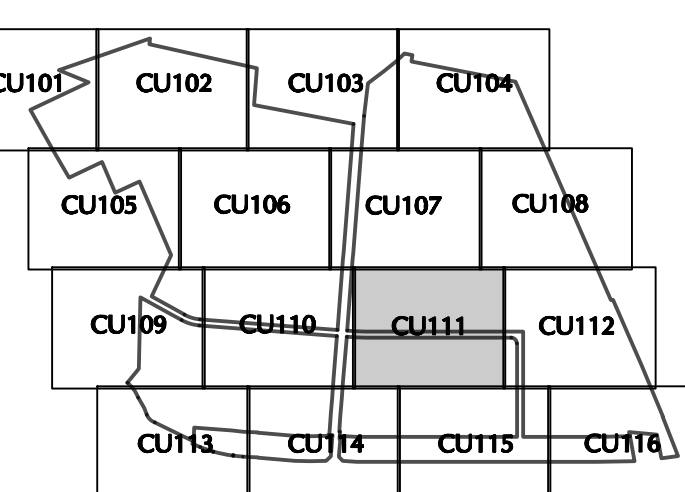

**UTILITY PLAN LEGEND**

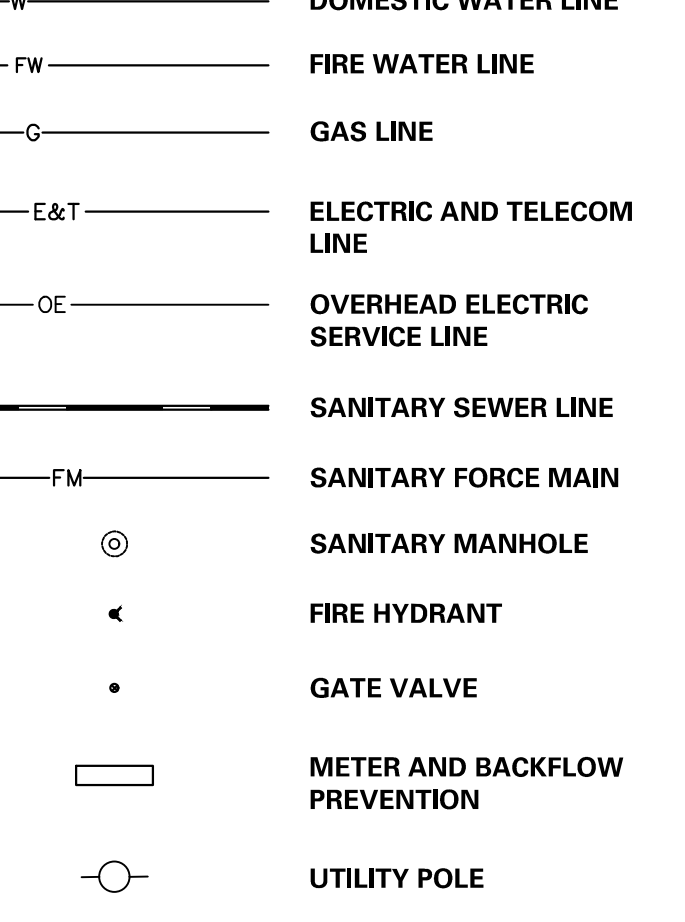

2/15/2021	Revised per Township Comments	2
12/3/2021	Completeness Revisions 1	1
Date	Description	No.

**REVISIONS**

*Chris Roche*  
 SIGNATURE CHRISTIAN ROCHE 11/12/2021  
 PROFESSIONAL ENGINEER NJ Lic. No. 240E04988100

**LANGAN**  
 Langan Engineering and Environmental Services, Inc.  
 989 Lenox Drive, Suite 124  
 Lawrenceville, NJ 08648  
 T: 609.282.8000 F: 609.282.8001 www.langan.com  
 NJ CERTIFICATE OF AUTHORIZATION No. 246A2798460

Project  
**BRIDGE POINT 8 INDUSTRIAL PARK**  
 WEST WINDSOR TOWNSHIP  
 MERCER COUNTY NEW JERSEY  
 Drawing Title

**UTILITY PLAN XI**

Project No.	Drawing No.
130172801	CU111
Date	Drawn By
12/03/2021	AMG
Checked By	CMR

**C1**  
**1,023,309 SF**

**FFE: 88.50** BUILDING C1 REQUIRES  
 EMPTY CONDUIT FOR 15  
 EV SPACES

A LOCK BOX TO ALLOW IMMEDIATE ACCESS  
 BY THE FIRE DEPARTMENT SHALL BE  
 INSTALLED AT THE FRONT OF EACH  
 BUILDING

MATCHLINE: CU111  
 MATCHLINE: CU115

MATCHLINE: CU111  
 MATCHLINE: CU114

PROJECT NO. 130172801

MATCHLINE: CU108  
MATCHLINE: CU112

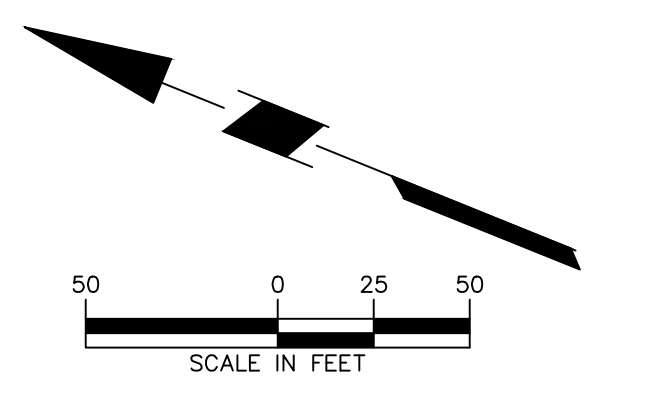

**SHEET LEGEND**

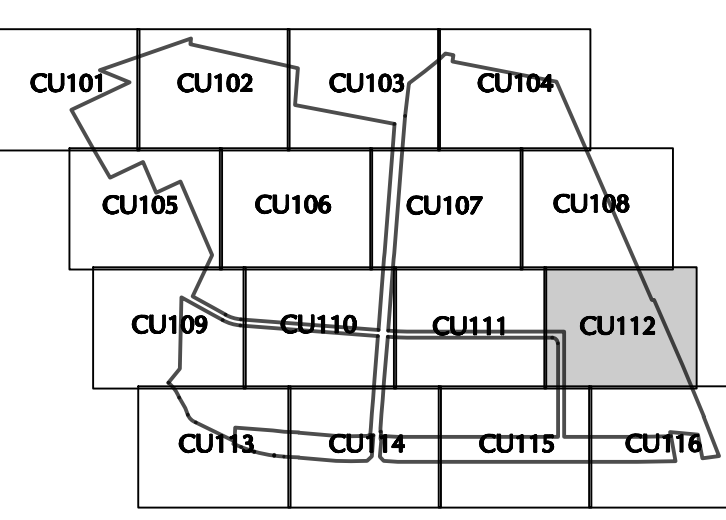

**UTILITY PLAN LEGEND**

- W — DOMESTIC WATER LINE
- FW — FIRE WATER LINE
- C — GAS LINE
- E&T — ELECTRIC AND TELECOM LINE
- OE — OVERHEAD ELECTRIC SERVICE LINE
- SSM — SANITARY SEWER LINE
- FM — SANITARY FORCE MAIN
- ⊙ — SANITARY MANHOLE
- ◀ — FIRE HYDRANT
- — GATE VALVE
- ▭ — METER AND BACKFLOW PREVENTION
- — UTILITY POLE

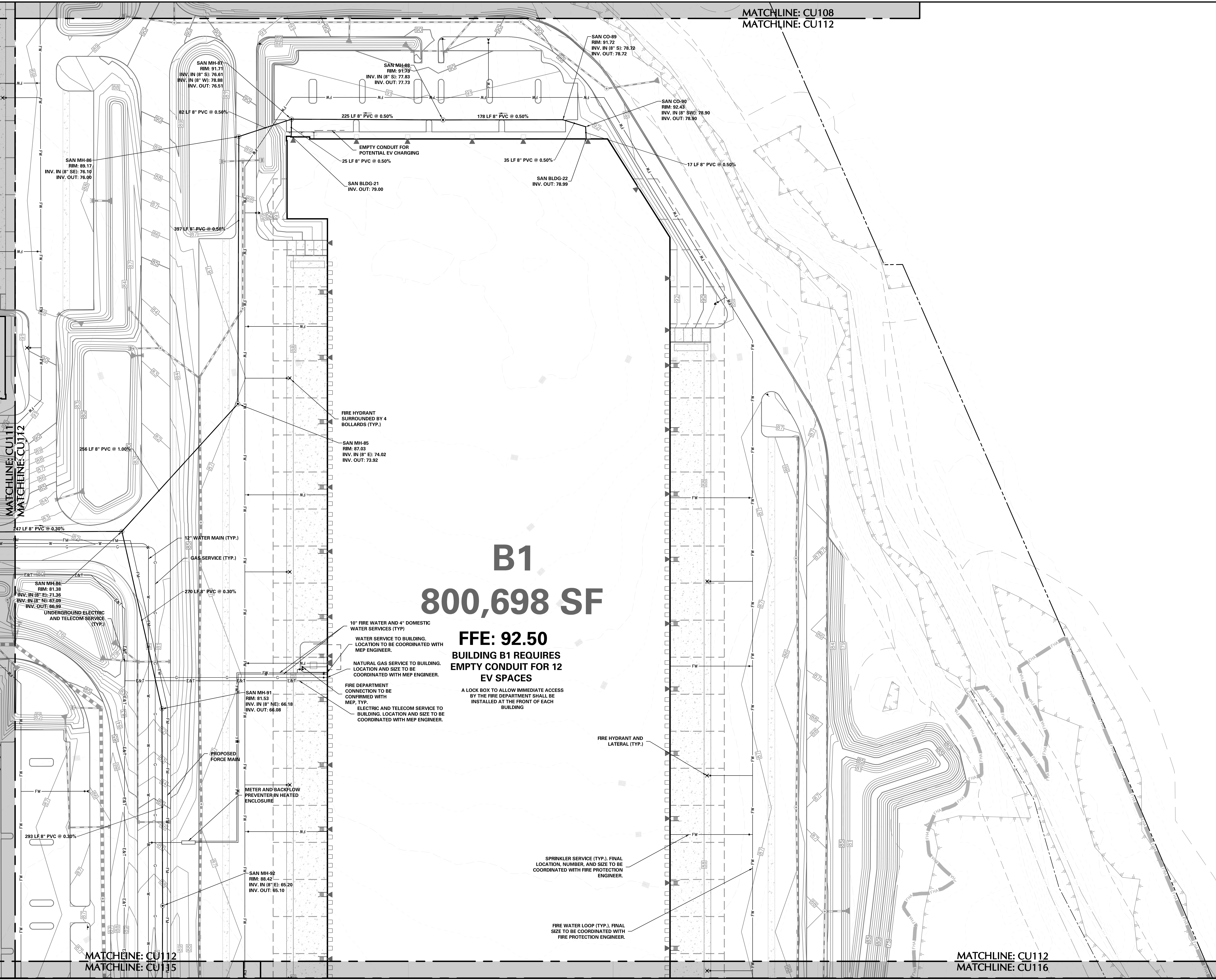

**B1**  
**800,698 SF**

**FFE: 92.50**  
**BUILDING B1 REQUIRES**  
**EMPTY CONDUIT FOR 12**  
**EV SPACES**

A LOCK BOX TO ALLOW IMMEDIATE ACCESS BY THE FIRE DEPARTMENT SHALL BE INSTALLED AT THE FRONT OF EACH BUILDING

FIRE HYDRANT SURROUNDED BY 4 BOLLARDS (TYP.)

SAN MH-85  
RIM: 87.03  
INV. IN (8" E): 74.02  
INV. OUT: 73.92

10" FIRE WATER AND 4" DOMESTIC WATER SERVICES (TYP.)  
WATER SERVICE TO BUILDING. LOCATION TO BE COORDINATED WITH MEP ENGINEER.

NATURAL GAS SERVICE TO BUILDING. LOCATION AND SIZE TO BE COORDINATED WITH MEP ENGINEER.

FIRE DEPARTMENT CONNECTION TO BE CONFIRMED WITH MEP, TYP.

ELECTRIC AND TELECOM SERVICE TO BUILDING. LOCATION AND SIZE TO BE COORDINATED WITH MEP ENGINEER.

FIRE HYDRANT AND LATERAL (TYP.)

SPRINKLER SERVICE (TYP.). FINAL LOCATION, NUMBER, AND SIZE TO BE COORDINATED WITH FIRE PROTECTION ENGINEER.

FIRE WATER LOOP (TYP.). FINAL SIZE TO BE COORDINATED WITH FIRE PROTECTION ENGINEER.

MATCHLINE: CU111  
MATCHLINE: CU112

MATCHLINE: CU112  
MATCHLINE: CU115

MATCHLINE: CU112  
MATCHLINE: CU116

2/15/2022	Revised per Township Comments	2
12/3/2021	Completeness Revisions 1	1
Date	Description	No.

REVISIONS

*Chris Roche*  
SIGNATURE CHRISTIAN ROCHE 11/12/2021  
PROFESSIONAL ENGINEER NJ Lic. No. 240E04988100

**LANGAN**  
Langan Engineering and Environmental Services, Inc.  
989 Lenox Drive, Suite 124  
Lawrenceville, NJ 08648  
T: 609.282.8000 F: 609.282.8001 www.langan.com  
NJ CERTIFICATE OF AUTHORIZATION No. 246A2796469

Project  
**BRIDGE POINT 8 INDUSTRIAL PARK**  
WEST WINDSOR TOWNSHIP  
MERCER COUNTY NEW JERSEY

**UTILITY PLAN XII**

Project No.	Drawing No.
130172801	CU112
Date	12/03/2021
Drawn By	AMG
Checked By	CMR

MATCHLINE: CU109  
MATCHLINE: CU113

MATCHLINE: CU110  
MATCHLINE: CU113

SAN CO-21  
RIM: 94.92  
INV. IN (8" S): 89.87  
INV. OUT: 89.87  
SAN BLDG-2  
INV. OUT: 90.00  
36 LF 8" PVC @ 0.35%

SPRINKLER SERVICE (TYP.). FINAL LOCATION, NUMBER, AND SIZE TO BE COORDINATED WITH FIRE PROTECTION ENGINEER.

FIRE HYDRANT SURROUNDED BY 4 BOLLARDS (TYP.)

FIRE WATER LOOP (TYP.). FINAL SIZE TO BE COORDINATED WITH FIRE PROTECTION ENGINEER.

PROPERTY LINE, TYP.

APPROXIMATE MUNICIPAL BOUNDARY LINE

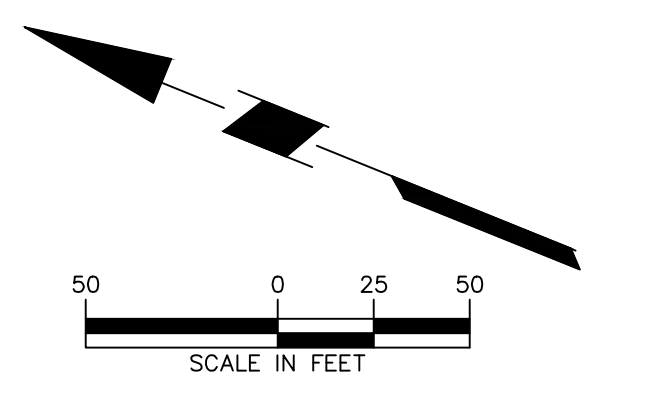

**SHEET LEGEND**

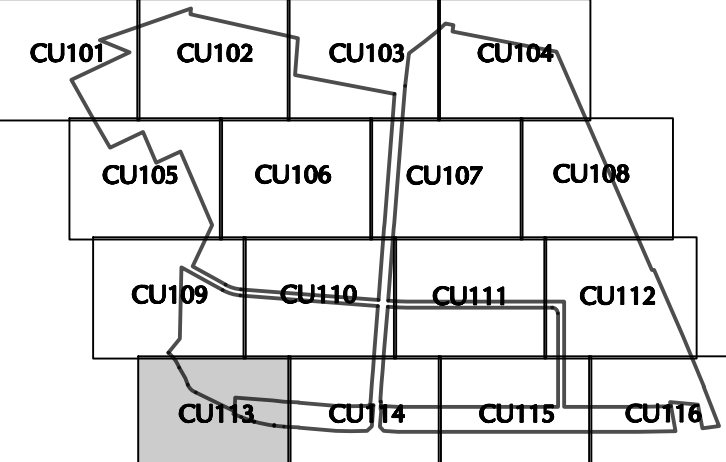

**UTILITY PLAN LEGEND**

- W — DOMESTIC WATER LINE
- FW — FIRE WATER LINE
- C — GAS LINE
- E&T — ELECTRIC AND TELECOM LINE
- OE — OVERHEAD ELECTRIC SERVICE LINE
- SS — SANITARY SEWER LINE
- FM — SANITARY FORCE MAIN
- ⊙ — SANITARY MANHOLE
- < — FIRE HYDRANT
- — GATE VALVE
- ▭ — METER AND BACKFLOW PREVENTION
- — UTILITY POLE

Date	Description	No.
2/15/2022	Revised per Township Comments	2
12/3/2021	Completeness Revisions 1	1

REVISIONS

*Chris Roche*  
SIGNATURE CHRISTIAN ROCHE 11/12/2021  
PROFESSIONAL ENGINEER NJ Lic. No. 240E04988100

**LANGAN**  
Langan Engineering and Environmental Services, Inc.  
989 Lenox Drive, Suite 124  
Lawrenceville, NJ 08648  
T: 609.282.8000 F: 609.282.8001 www.langan.com  
NJ CERTIFICATE OF AUTHORIZATION No. 246A2798469

Project  
**BRIDGE POINT 8 INDUSTRIAL PARK**  
WEST WINDSOR TOWNSHIP  
MERCER COUNTY NEW JERSEY

**UTILITY PLAN XIII**

Project No. 130172801	Drawing No. <b>CU113</b>
Date 12/03/2021	
Drawn By AMG	
Checked By CMR	

MATCHLINE: CU110  
MATCHLINE: CU114

MATCHLINE: CU111  
MATCHLINE: CU114

MATCHLINE: CU113  
MATCHLINE: CU114

MATCHLINE: CU114  
MATCHLINE: CU115

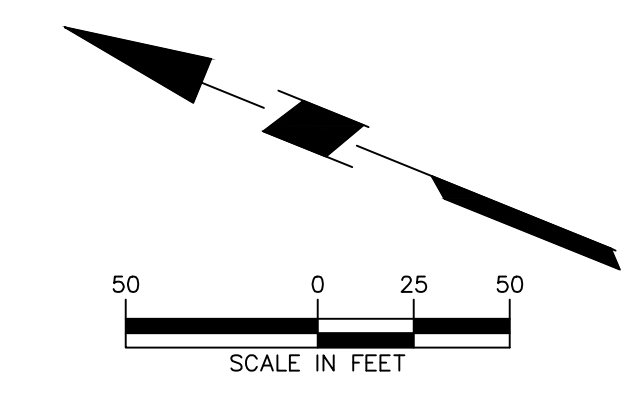

**SHEET LEGEND**

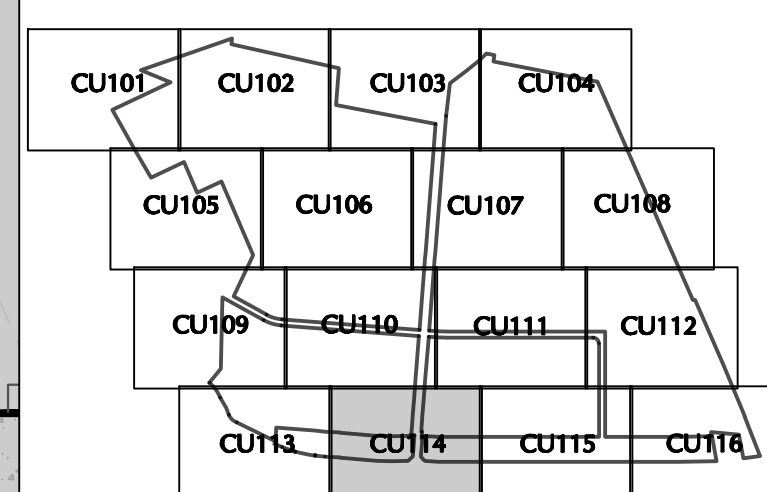

**UTILITY PLAN LEGEND**

- DOMESTIC WATER LINE
- FW FIRE WATER LINE
- GAS LINE
- E&T ELECTRIC AND TELECOM LINE
- OE OVERHEAD ELECTRIC SERVICE LINE
- SANITARY SEWER LINE
- FM SANITARY FORCE MAIN
- ⊙ SANITARY MANHOLE
- ◀ FIRE HYDRANT
- GATE VALVE
- ◻ METER AND BACKFLOW PREVENTION
- UTILITY POLE

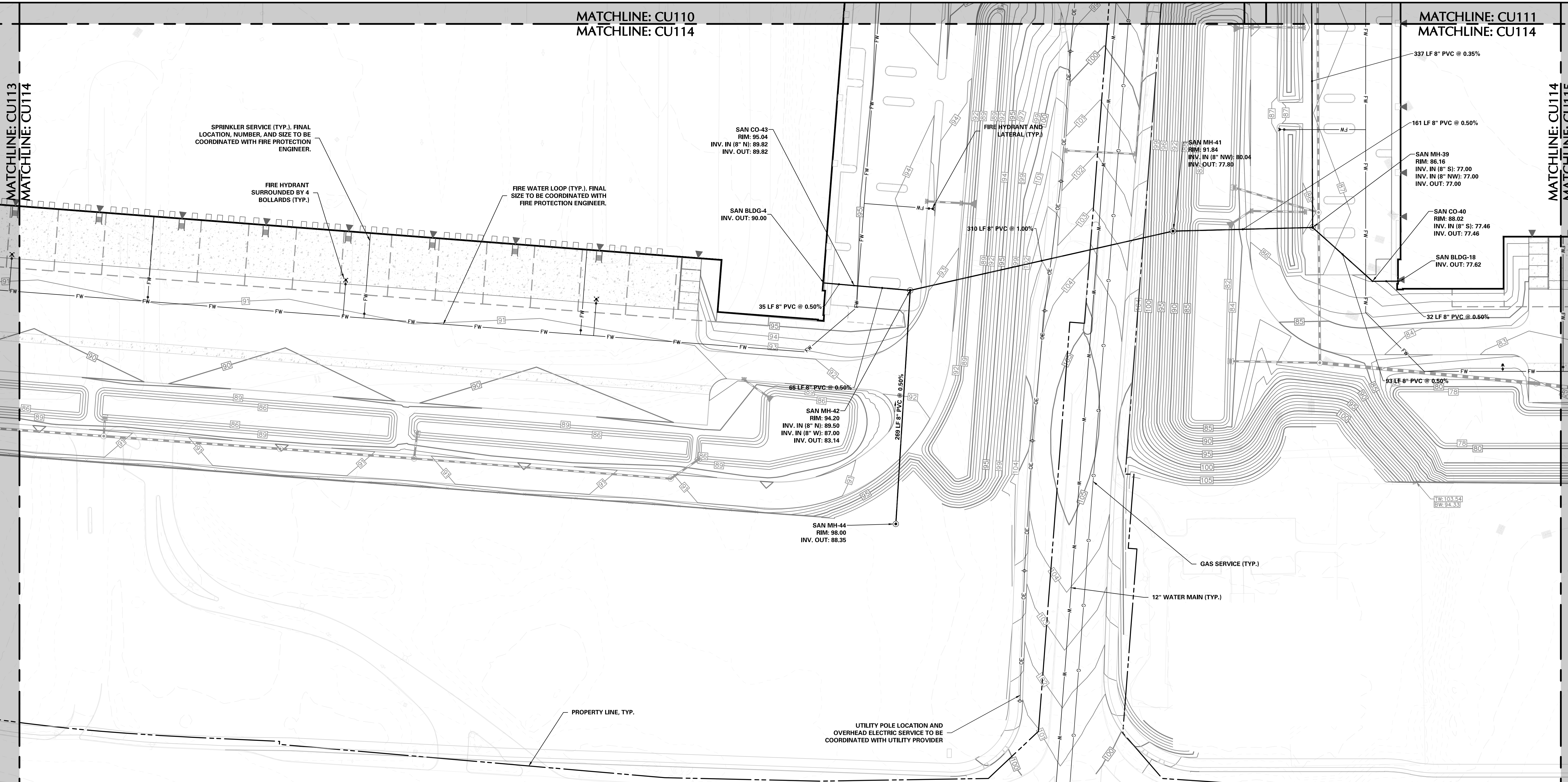

SPRINKLER SERVICE (TYP.). FINAL LOCATION, NUMBER, AND SIZE TO BE COORDINATED WITH FIRE PROTECTION ENGINEER.

FIRE HYDRANT SURROUNDED BY 4 BOLLARDS (TYP.)

FIRE WATER LOOP (TYP.). FINAL SIZE TO BE COORDINATED WITH FIRE PROTECTION ENGINEER.

SAN CO-43  
RIM: 95.04  
INV. IN (8" N): 89.82  
INV. OUT: 89.82

SAN BLDG-4  
INV. OUT: 90.00

35 LF 8" PVC @ 0.50%

FIRE HYDRANT AND LATERAL (TYP.)

310 LF 8" PVC @ 1.00%

SAN MH-41  
RIM: 91.84  
INV. IN (8" NW): 80.04  
INV. OUT: 77.80

337 LF 8" PVC @ 0.35%

161 LF 8" PVC @ 0.50%

SAN MH-39  
RIM: 86.16  
INV. IN (8" S): 77.00  
INV. IN (8" NW): 77.00  
INV. OUT: 77.00

SAN CO-40  
RIM: 88.02  
INV. IN (8" S): 77.46  
INV. OUT: 77.46

SAN BLDG-18  
INV. OUT: 77.62

32 LF 8" PVC @ 0.50%

68 LF 8" PVC @ 0.50%

SAN MH-42  
RIM: 94.20  
INV. IN (8" N): 89.50  
INV. IN (8" W): 87.00  
INV. OUT: 83.14

SAN MH-44  
RIM: 98.00  
INV. OUT: 88.35

288 LF 8" PVC @ 0.50%

GAS SERVICE (TYP.)

12" WATER MAIN (TYP.)

PROPERTY LINE, TYP.

UTILITY POLE LOCATION AND OVERHEAD ELECTRIC SERVICE TO BE COORDINATED WITH UTILITY PROVIDER

NATURAL GAS SERVICE CONNECTION TO BE COORDINATED WITH UTILITY PROVIDER

CONNECTION TO EXISTING 12" WATER MAIN IN QUAKERBRIDGE ROAD TO BE COORDINATED WITH UTILITY PROVIDER (PSE&G)

Date	Description	No.
2/15/2022	Revised per Township Comments	2
12/3/2021	Completeness Revisions	1

REVISIONS

*Chris Roche*  
SIGNATURE CHRISTIAN ROCHE 11/12/2021  
PROFESSIONAL ENGINEER NJ Lic. No. 240E04988100

**LANGAN**  
Langan Engineering and Environmental Services, Inc.  
989 Lenox Drive, Suite 124  
Lawrenceville, NJ 08648  
T: 609.282.8000 F: 609.282.8001 www.langan.com  
NJ CERTIFICATE OF AUTHORIZATION No. 246A2798490

Project  
**BRIDGE POINT 8 INDUSTRIAL PARK**  
WEST WINDSOR TOWNSHIP  
MERCER COUNTY NEW JERSEY

**UTILITY PLAN XIV**

Project No.	Drawing No.
130172801	CU114
Date	Drawn By
12/03/2021	AMG
Checked By	CMR

MATCHLINE: CU111  
MATCHLINE: CU115

MATCHLINE: CU112  
MATCHLINE: CU115

MATCHLINE: CU114  
MATCHLINE: CU115

MATCHLINE: CU115  
MATCHLINE: CU116

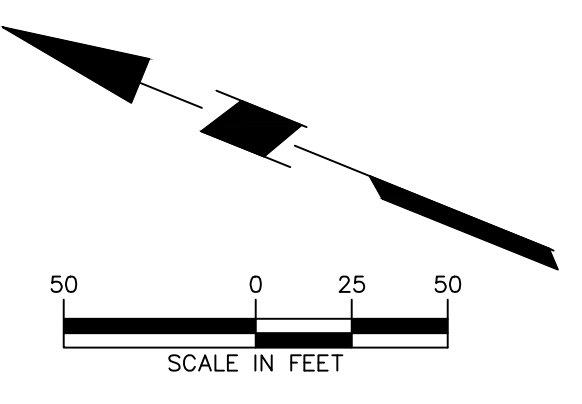

**SHEET LEGEND**

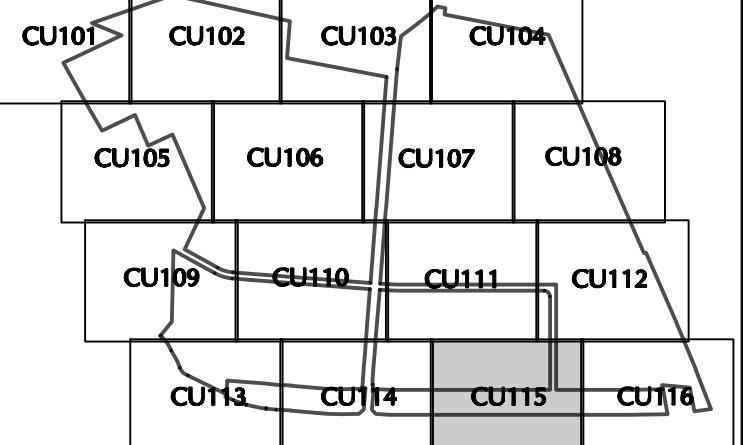

**UTILITY PLAN LEGEND**

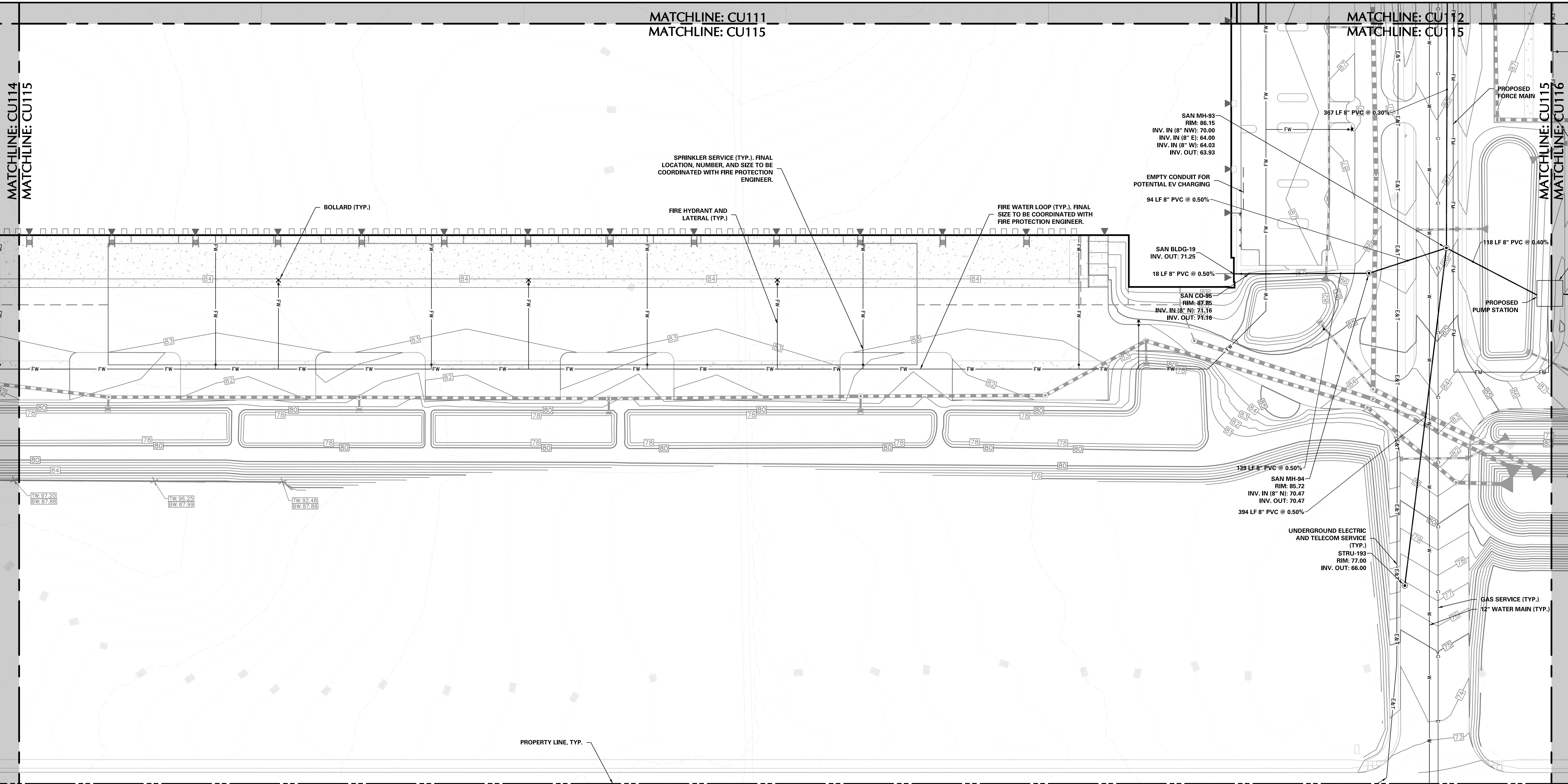
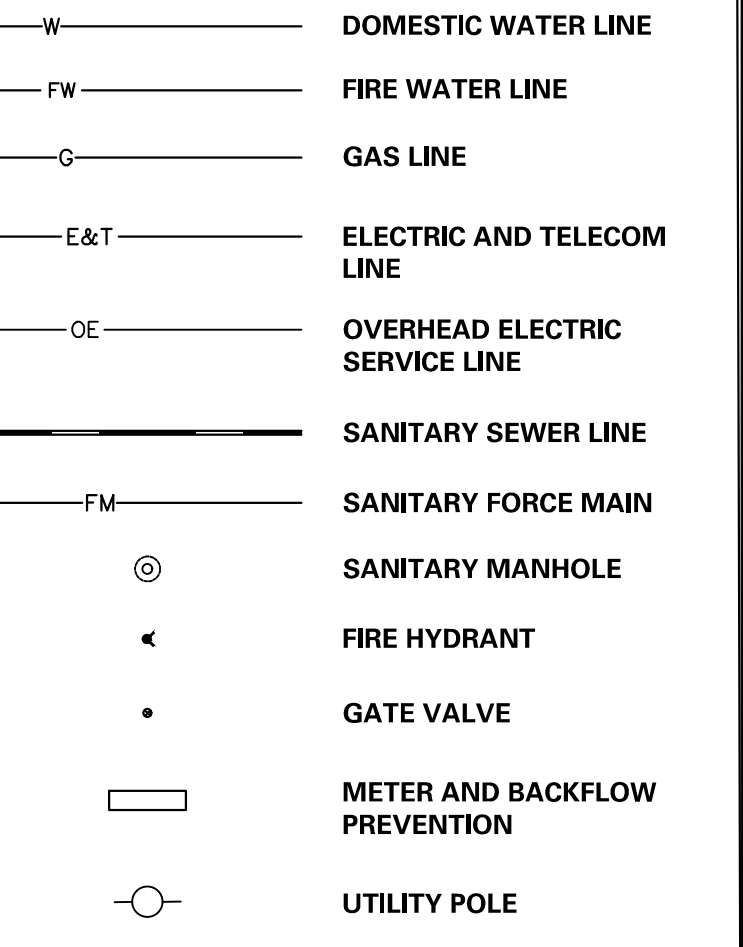

**QUAKERBRIDGE ROAD**  
(AKA PROVINCE LINE ROAD)  
(PUBLIC, 90' WIDE PER TAX MAP)

2/15/2022	Revised per Township Comments	2
12/3/2021	Completeness Revisions 1	1
Date	Description	No.

REVISIONS

*Chris Roche*

SIGNATURE CHRISTIAN ROCHE 11/12/2021  
PROFESSIONAL ENGINEER NJ Lic. No. 240E04988100

**LANGAN**

Langan Engineering and Environmental Services, Inc.  
989 Lenox Drive, Suite 124  
Lawrenceville, NJ 08648

T: 609.282.8000 F: 609.282.8001 www.langan.com  
NJ CERTIFICATE OF AUTHORIZATION No. 246A2798490

Project  
**BRIDGE POINT 8 INDUSTRIAL PARK**  
WEST WINDSOR TOWNSHIP  
MERCER COUNTY NEW JERSEY  
Drawing Title

**UTILITY PLAN XV**

Project No.	Drawing No.
130172801	CU115
Date	Drawn By
12/03/2021	AMG
Checked By	CMR



MATCHLINE: CU112  
MATCHLINE: CU116

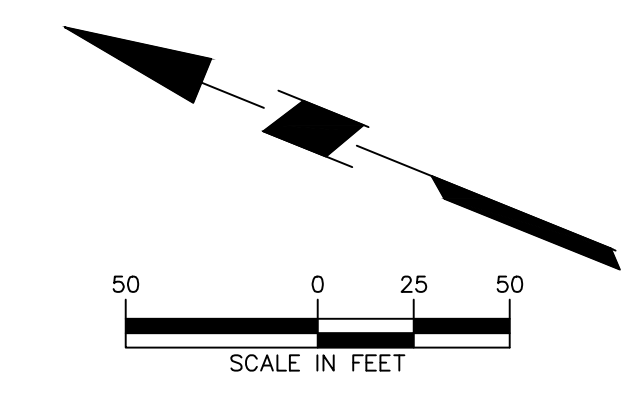

**SHEET LEGEND**

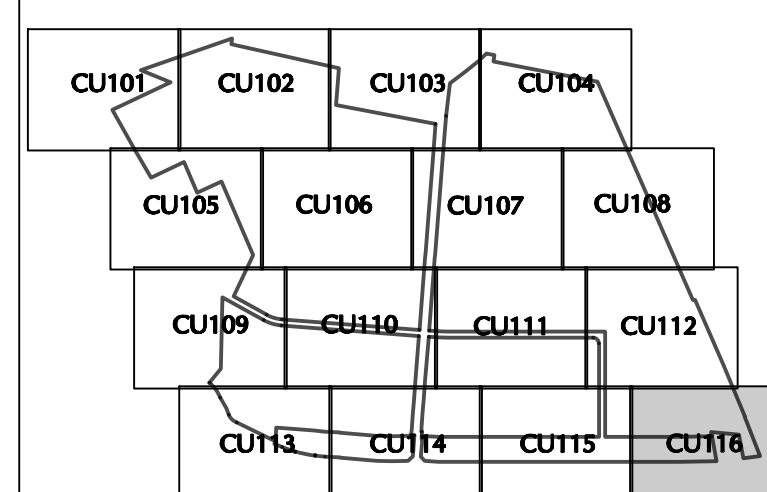

**UTILITY PLAN LEGEND**

- W — DOMESTIC WATER LINE
- FW — FIRE WATER LINE
- C — GAS LINE
- E&T — ELECTRIC AND TELECOM LINE
- OE — OVERHEAD ELECTRIC SERVICE LINE
- SS — SANITARY SEWER LINE
- FM — SANITARY FORCE MAIN
- ⊙ — SANITARY MANHOLE
- ◀ — FIRE HYDRANT
- — GATE VALVE
- ▭ — METER AND BACKFLOW PREVENTION
- — UTILITY POLE

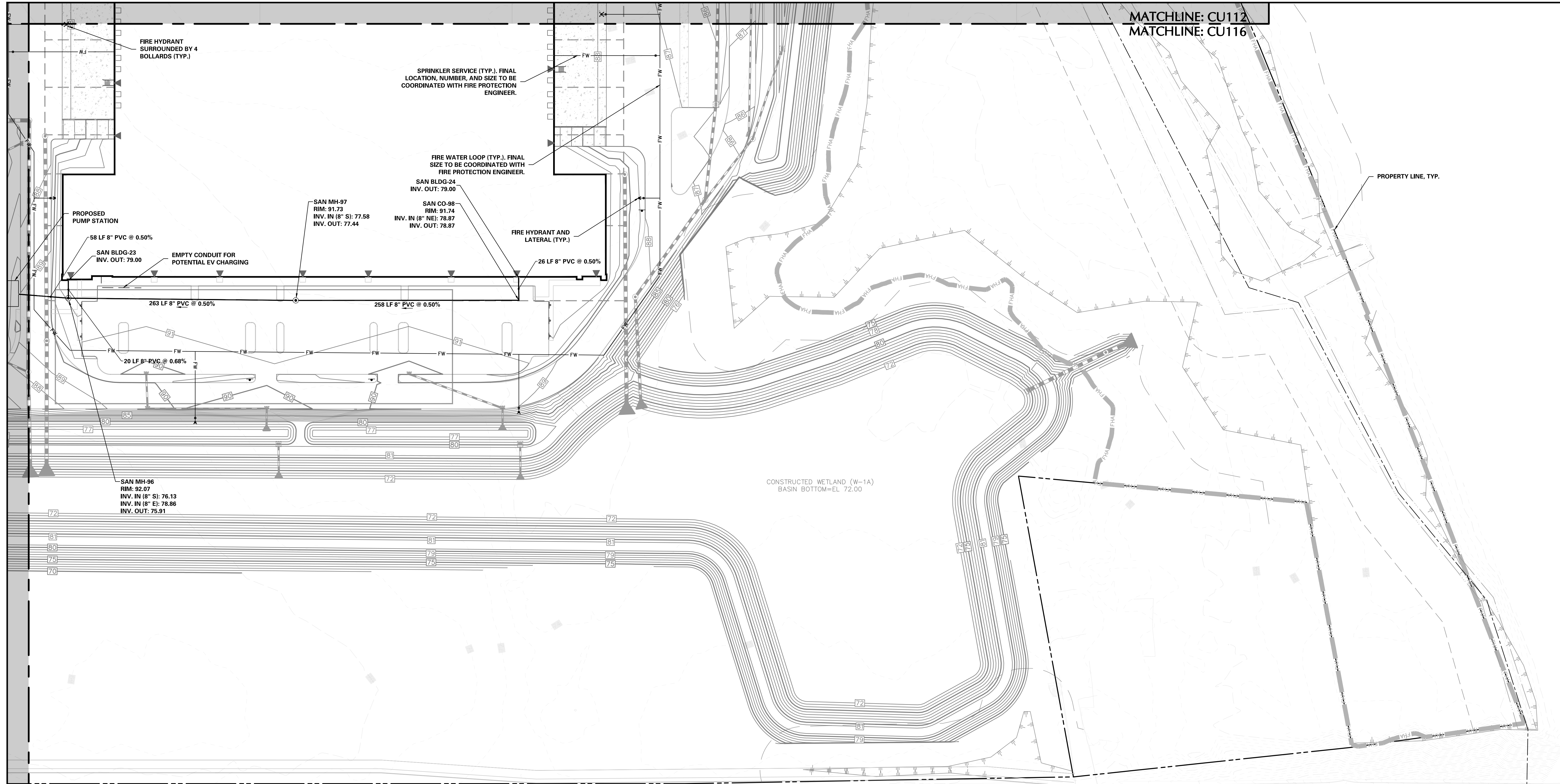

MATCHLINE: CU115  
MATCHLINE: CU116

2/15/2022	Revised per Township Comments	2
12/3/2021	Completeness Revisions 1	1
Date	Description	No.

REVISIONS

*Chris Roche*  
SIGNATURE CHRISTIAN ROCHE 11/12/2021  
PROFESSIONAL ENGINEER NJ Lic. No. 240E04988100

**LANGAN**  
Langan Engineering and Environmental Services, Inc.  
989 Lenox Drive, Suite 124  
Lawrenceville, NJ 08648  
T: 609.282.8000 F: 609.282.8001 www.langan.com  
NJ CERTIFICATE OF AUTHORIZATION No. 246A27986409

Project  
**BRIDGE POINT 8 INDUSTRIAL PARK**  
WEST WINDSOR TOWNSHIP  
MERCER COUNTY NEW JERSEY  
Drawing Title

**UTILITY PLAN XVI**

Project No.	Drawing No.
130172801	CU116
Date	12/03/2021
Drawn By	AMG
Checked By	CMR